

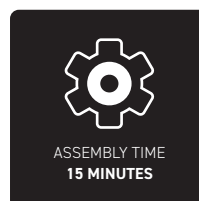

# **Assembly Guide** and **User Manual**

## **Secretlab® MAGNUS Metal Desk**

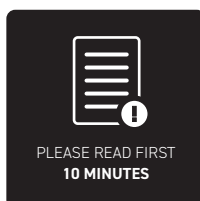

# CONTENTS

---

<b>Important Safety Instructions</b>	1
<b>Warnings and Caution</b>	1
<b>Use and Liability</b>	1
<b>Technical Specifications</b>	2
<b>What's In the Box</b>	3
<b>Assembly Tool Kit</b>	3
<b>Assembly Guide</b>	4
Assembling the Secretlab MAGNUS	4
Installing the Secretlab MAGPAD™	8
Final Touches	10
<b>Usage Instructions</b>	11
Handling the Hinged Rear Cover	11
Mounting a Monitor Arm	11
Mounting the Tray Passthrough Cover	12
<b>Disposal of your Old Product</b>	12

# IMPORTANT SAFETY INSTRUCTIONS

 PLEASE READ PRIOR TO INSTALLATION AND USE

This user manual contains important safety regulations. Any non-conforming use may result in personal injury or mechanical damage. Please read this user manual carefully before use as it provides key information about safety, use, assembly and maintenance of the Secretlab MAGNUS Metal Desk.

Close supervision is necessary when this desk is near children, invalids, or disabled persons. Use this desk only for its intended use as described in these instructions. Do not use attachments not recommended by the manufacturer. The Secretlab MAGNUS Metal Desk is designed for indoor use and dry work areas only. Do not use outdoors. Do not operate in environments with high heat, high humidity, high salinity or pollutant gases.

## WARNINGS AND CAUTION

Ensure you have received all parts according to the **What's In the Box** section (pg.3) prior to installation. If any parts are missing or faulty, contact the Secretlab support team for replacements. The Secretlab MAGNUS Metal Desk is to be assembled by at least two people. This product contains small items that could be a choking hazard if swallowed. Keep these items away from children and pets. Do not overtighten the screws during installation.

	This desk is not intended for use by children without adult supervision.		Do not stand on the desk and do not use the desk as a climbing aid.
	Do not exceed the maximum load capacity of the Metal Desk Top (100kg/220lb). Do not load the Hinged Rear Cover.		Do not sit on the desk.
	Do not adjust the desk height when there is load on the Metal Desk Top.		Do not drag the desk across the floor. Do not wobble the desk forcefully on purpose.
	Do not crawl or lie under the desk frame.		Do not place your hands or fingers between the Hinged Rear Cover and Metal Desk Top.

## USE AND LIABILITY



Under no circumstances does the manufacturer accept warranty claims or liability claims for damages caused from improper use or handling of the desk. For warranty terms and service or any other queries, scan the QR code or visit our website [secretlab.co/support](https://secretlab.co/support).

TECHNICAL SPECIFICATIONS

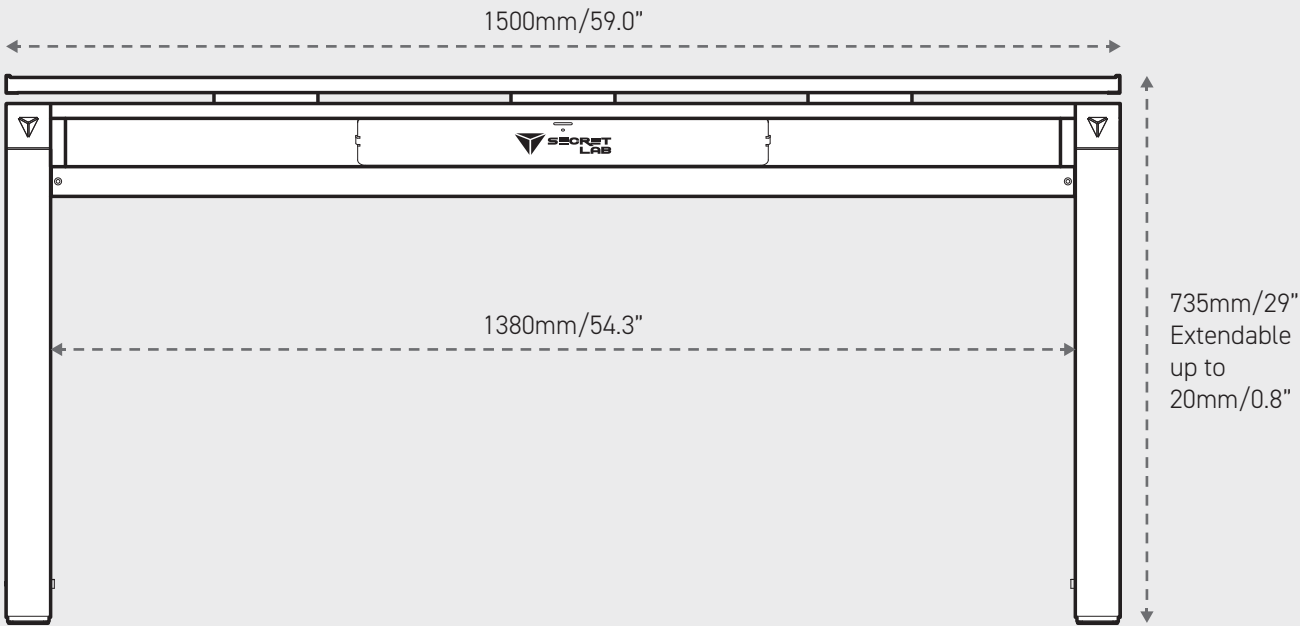
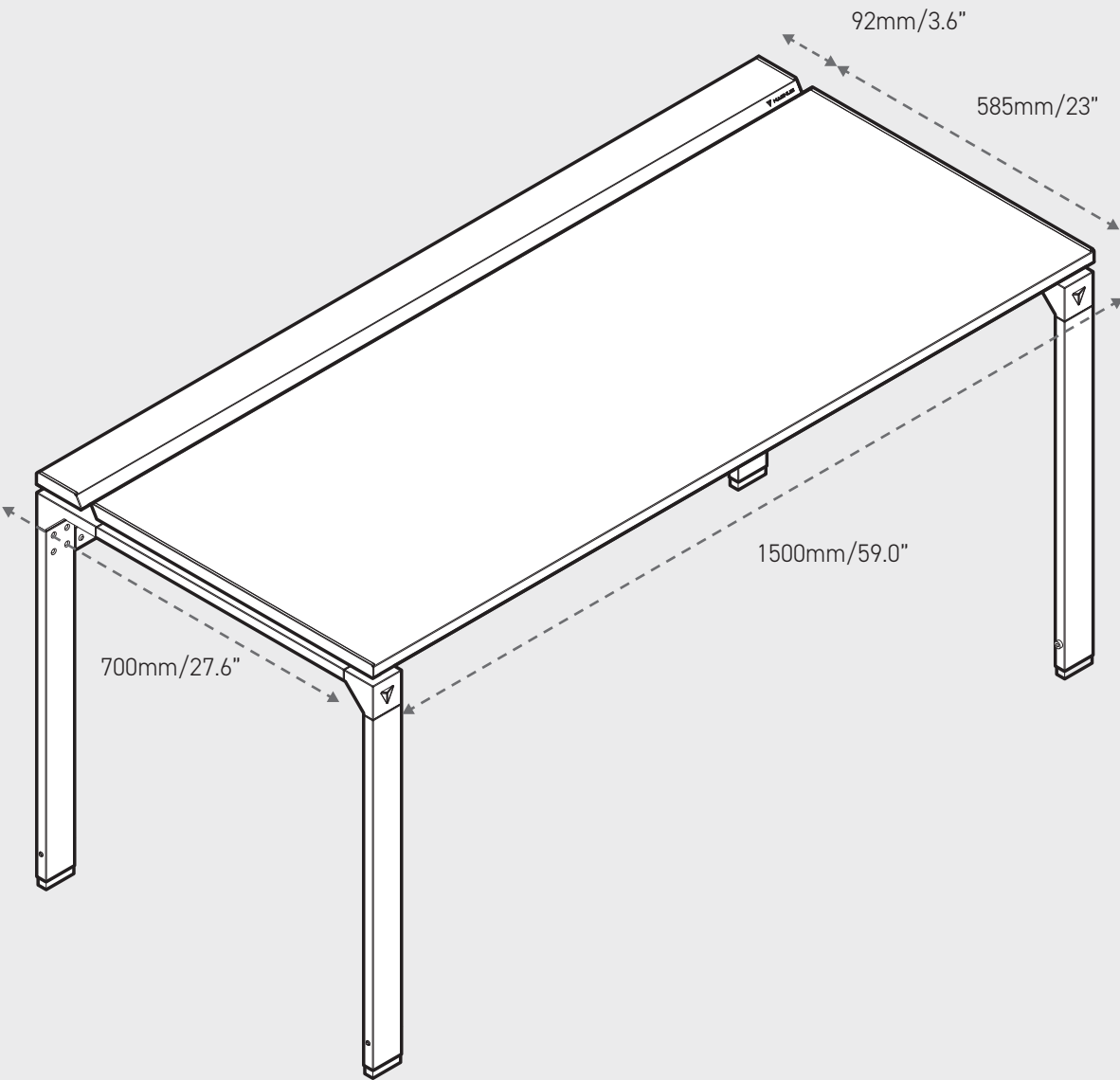

WHAT'S IN THE BOX

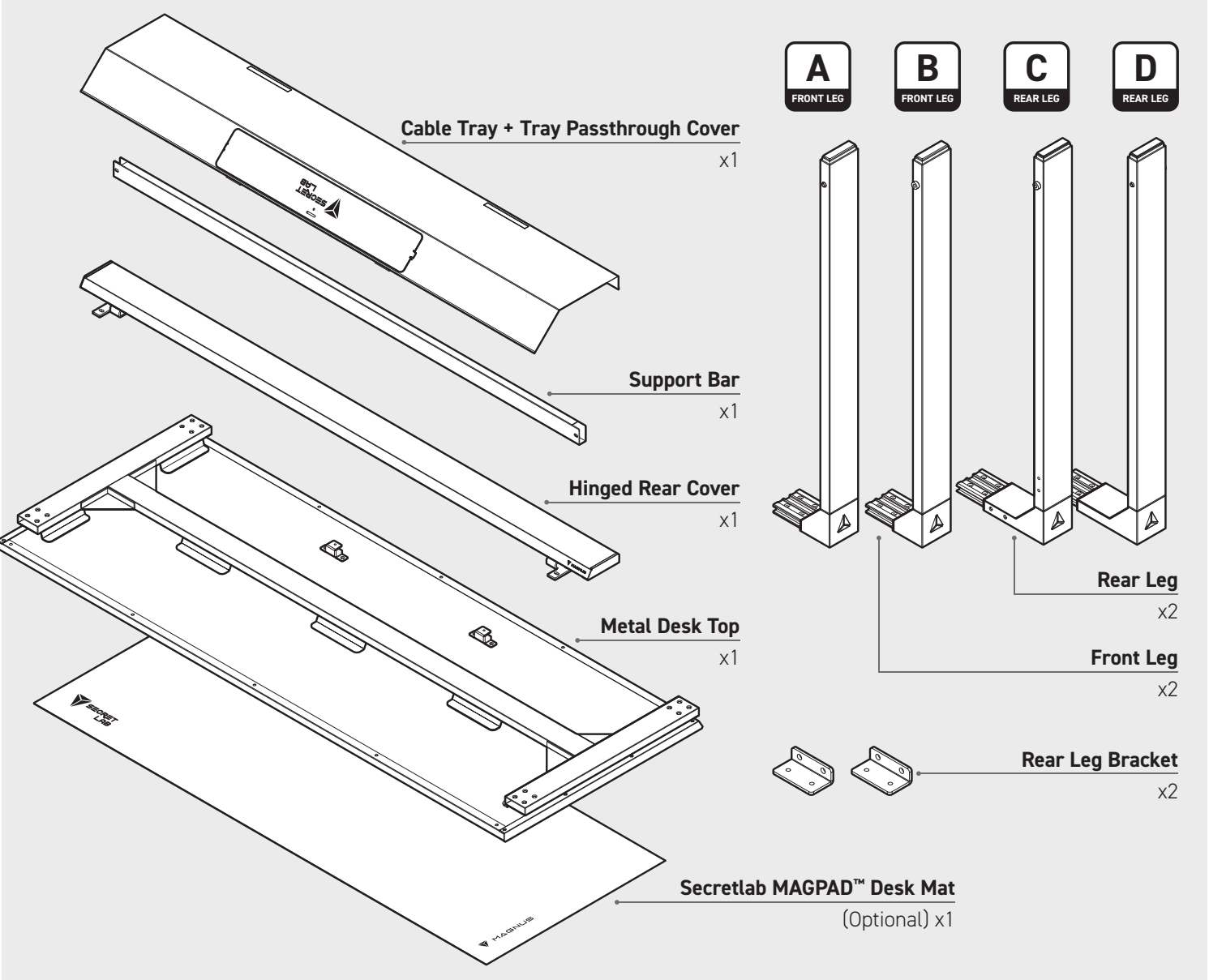

ASSEMBLY TOOL KIT

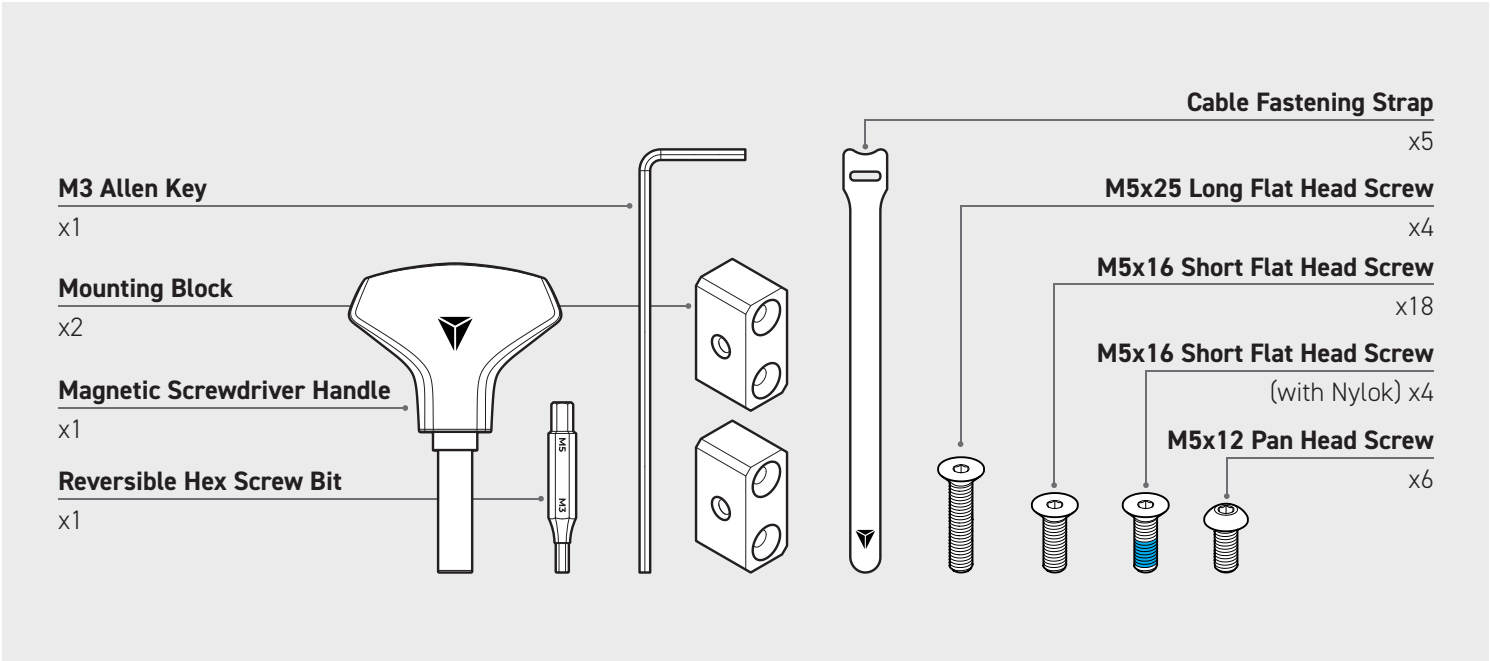

## 01 Assembling the Secretlab MAGNUS



With at least two people, lift the **Metal Desk Top** and place it upside down onto a debris-free area to protect the **Metal Desk Top** surface.

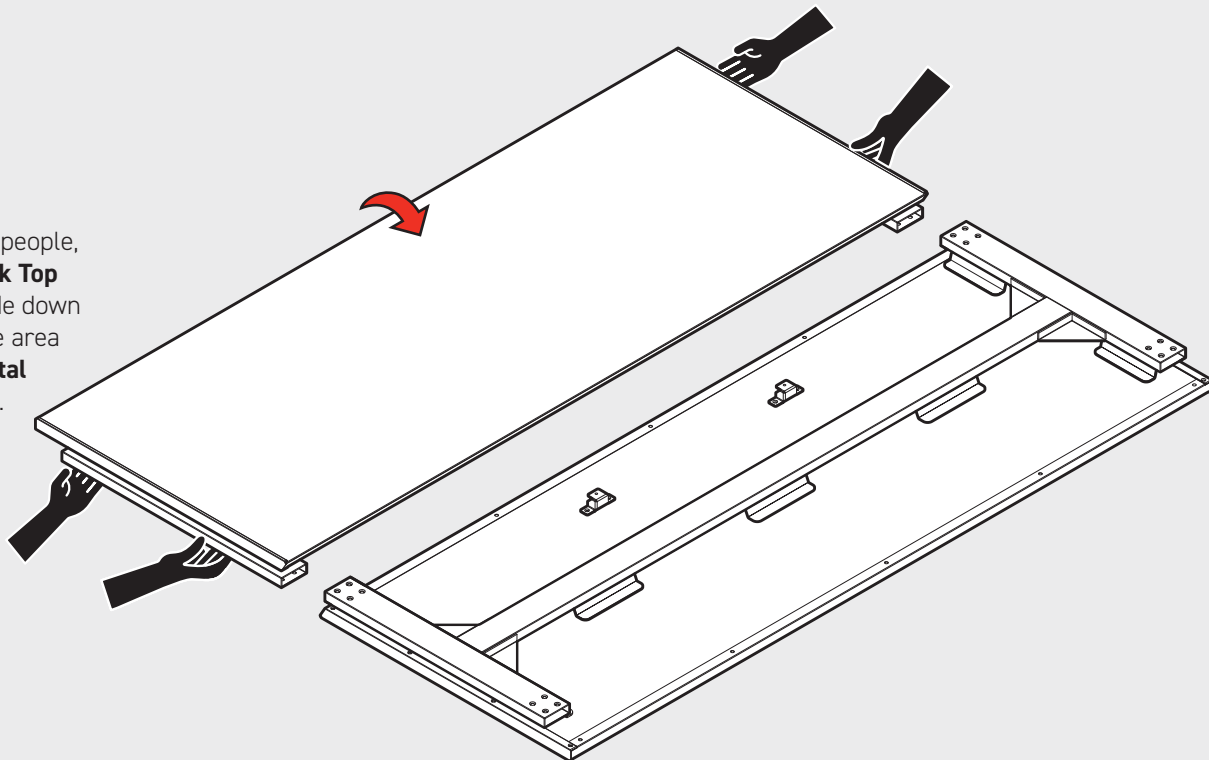

## 02

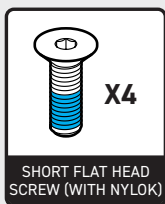

Align the **Rear Leg Brackets** onto the **Rear Legs** and screw in the fasteners.

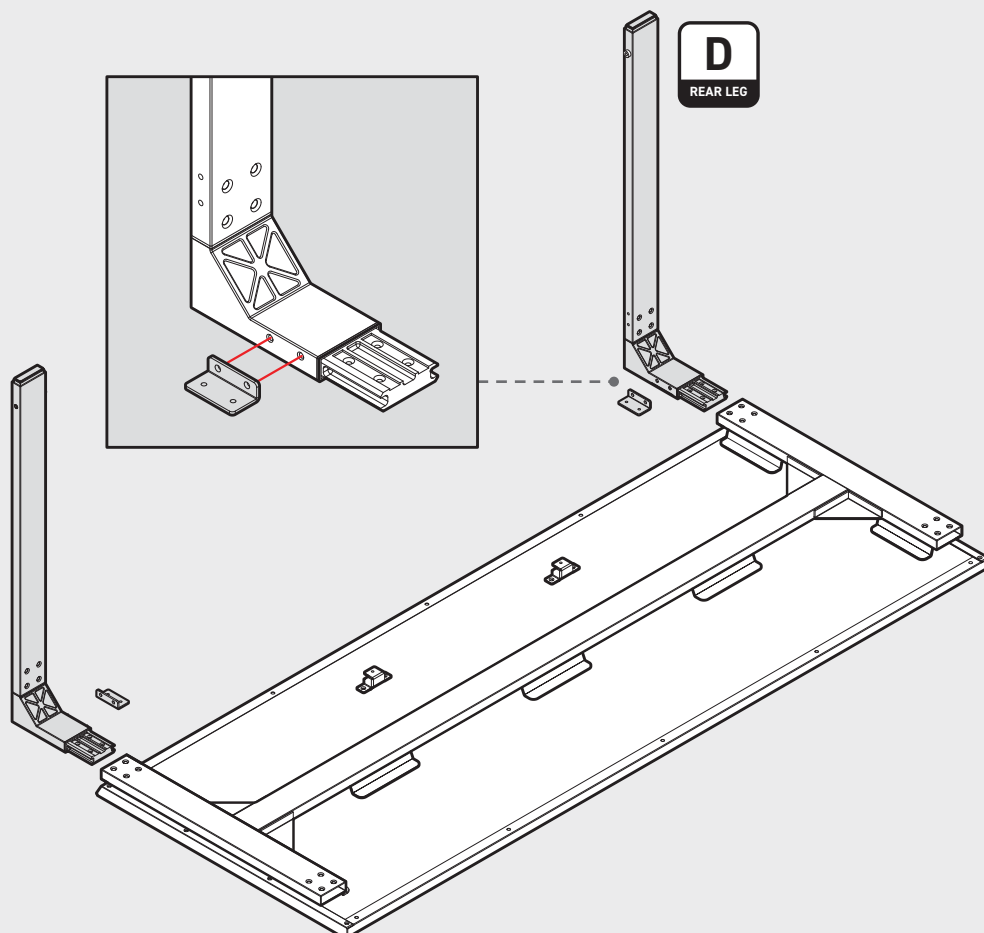
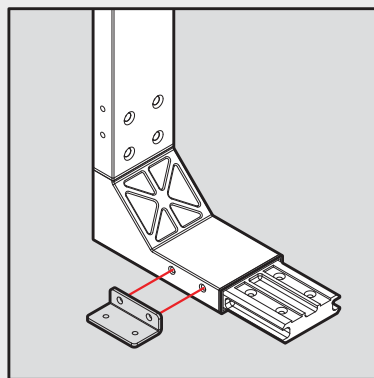

## ASSEMBLY GUIDE

03

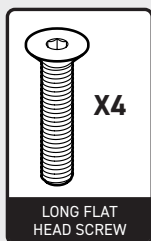

Align the **Mounting Blocks** onto the **Rear Legs** and screw in the fasteners.

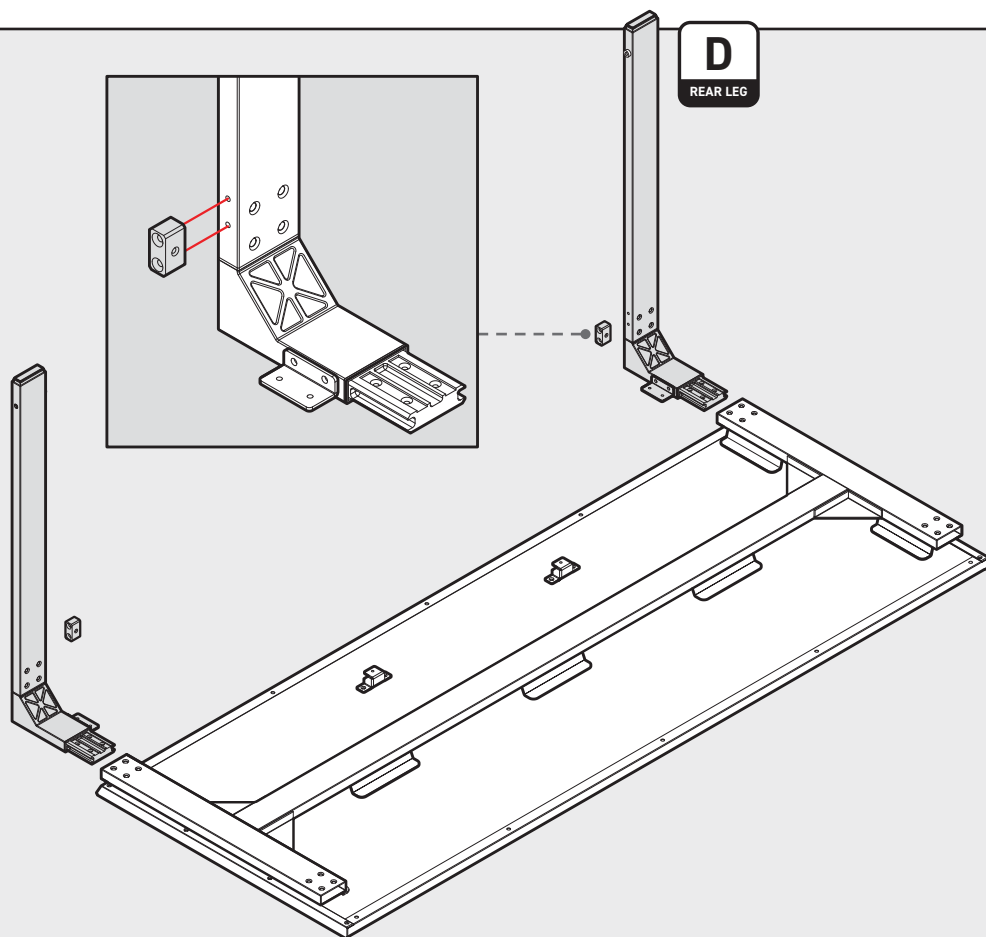
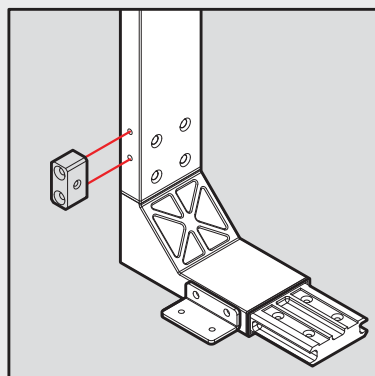

04

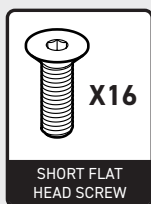

Remove the straps and slot the **Desk Legs** into the **Metal Desk Top** and tighten the fasteners in a diagonal sequence.

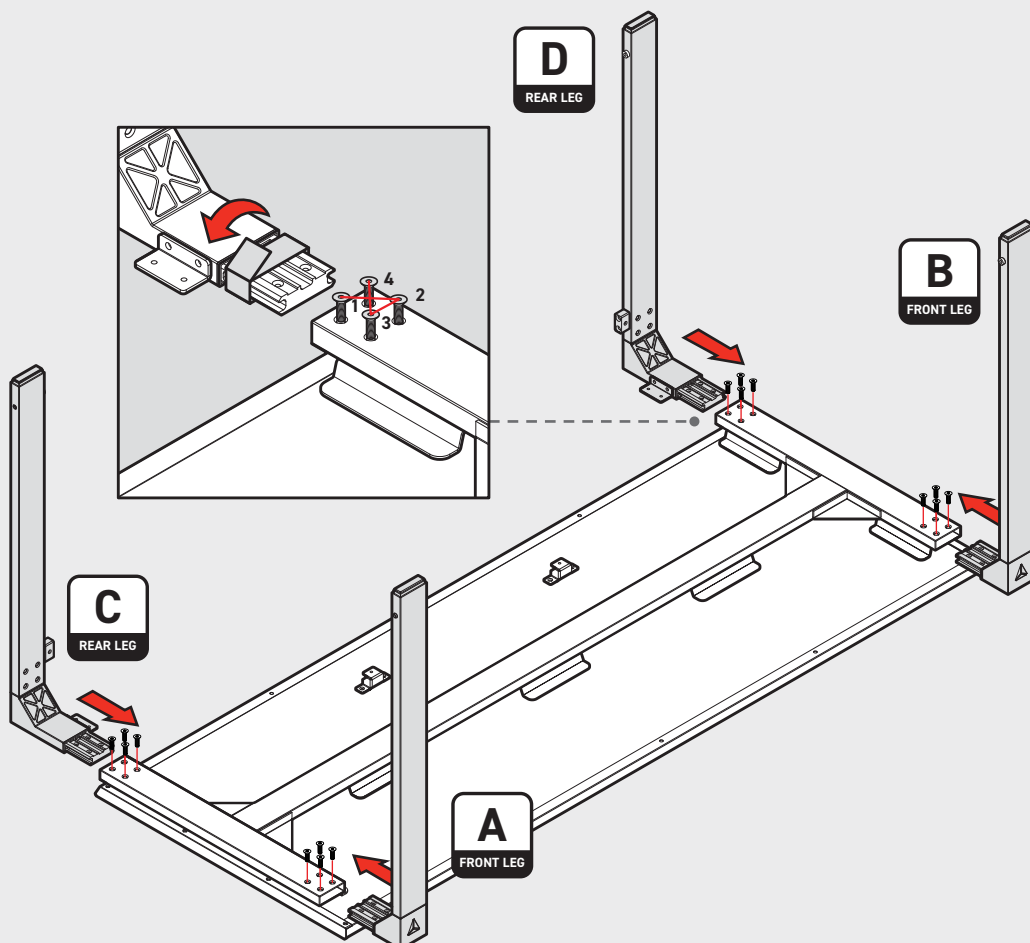
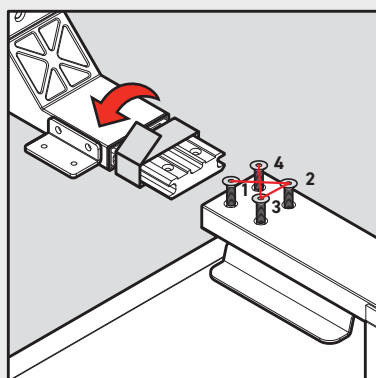

## ASSEMBLY GUIDE

05



Slot the **Support Bar** upward onto the **Mounting Blocks** and screw in the fasteners.

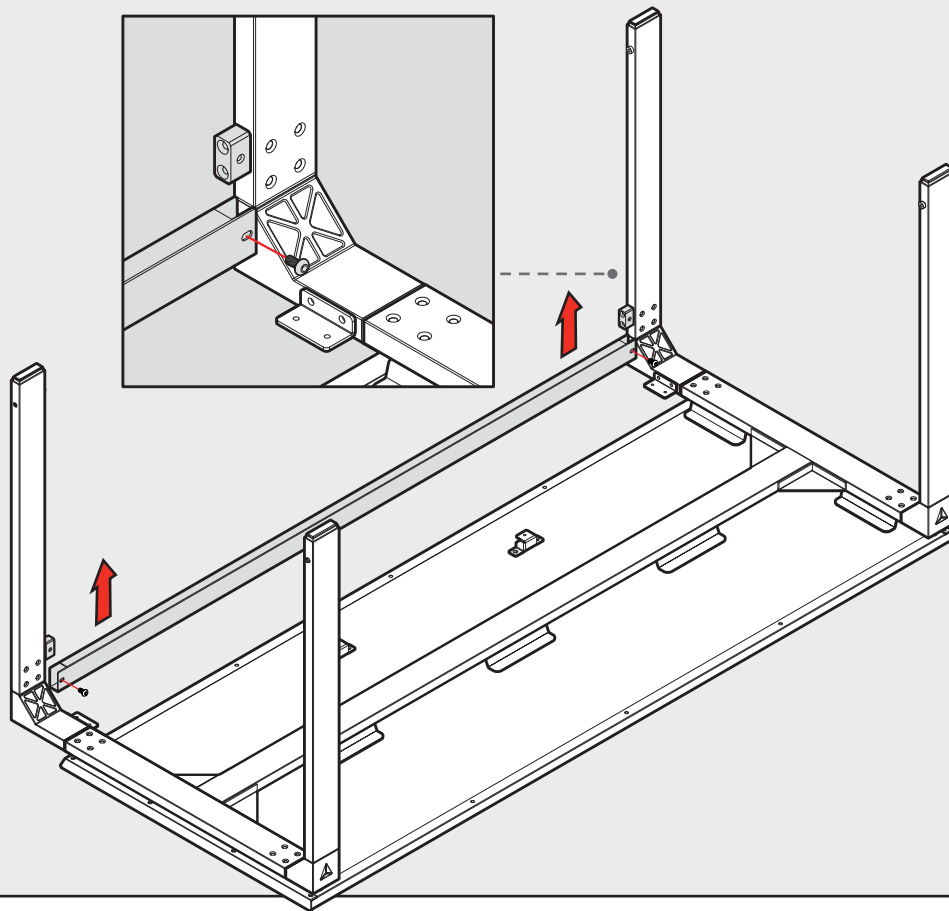

06

Remove the **Tray Passthrough Cover**. Align and attach the back of the **Cable Tray** onto the **Support Bar** magnetically.

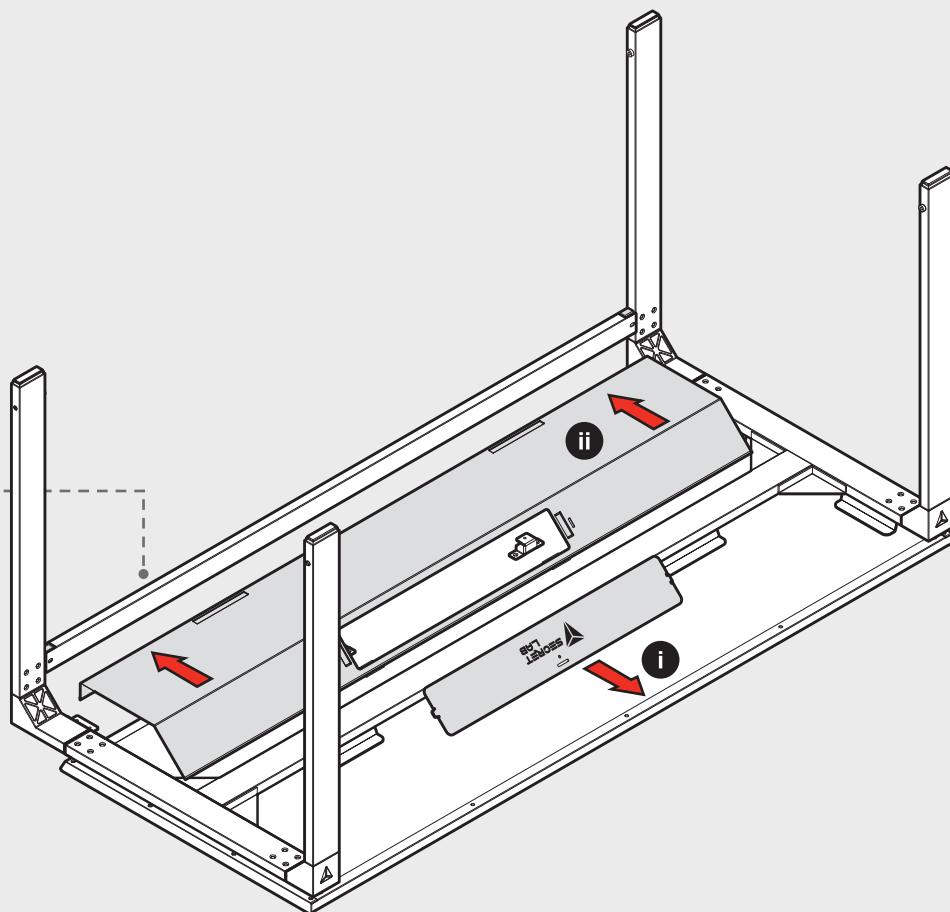
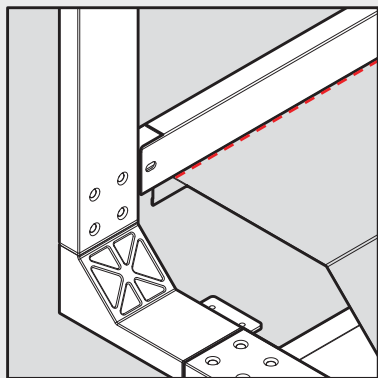



## ASSEMBLY GUIDE

07

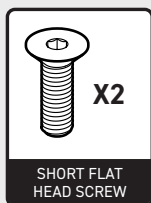

Once the back of the **Cable Tray** is magnetically attached onto the **Support Bar**, screw in the fasteners at the front of the Cable Tray.

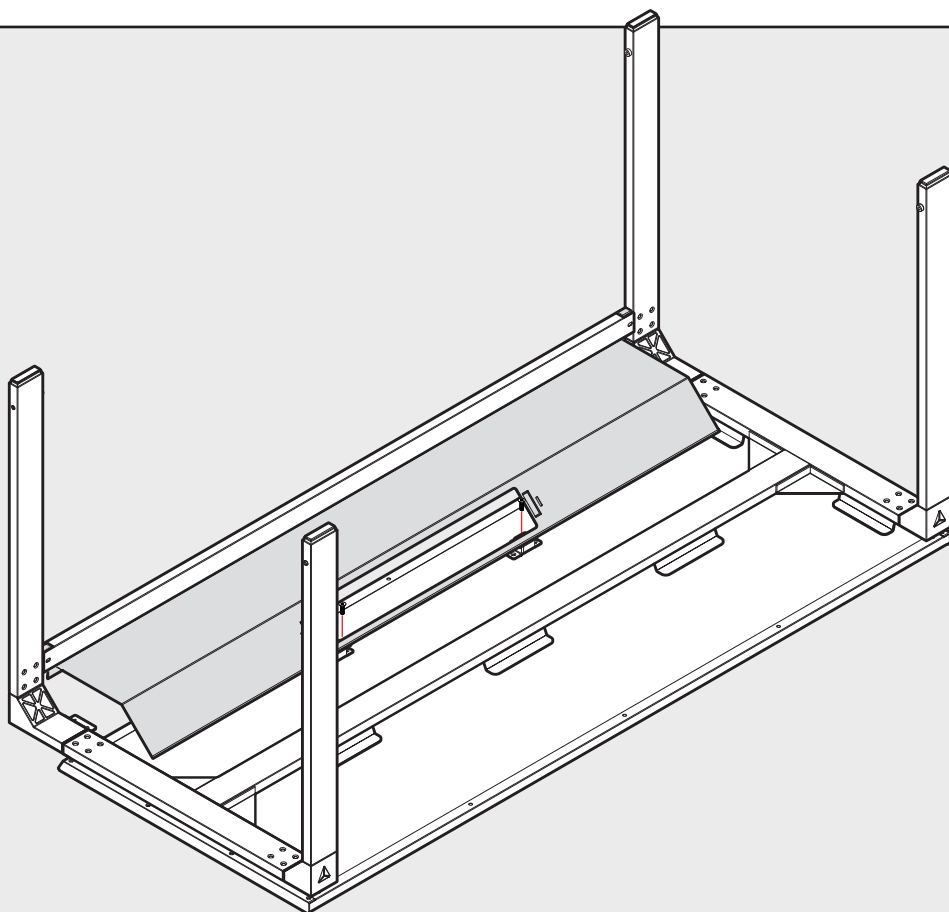

08



With at least two people, lift and flip the desk without resting weight on the sides of the legs.

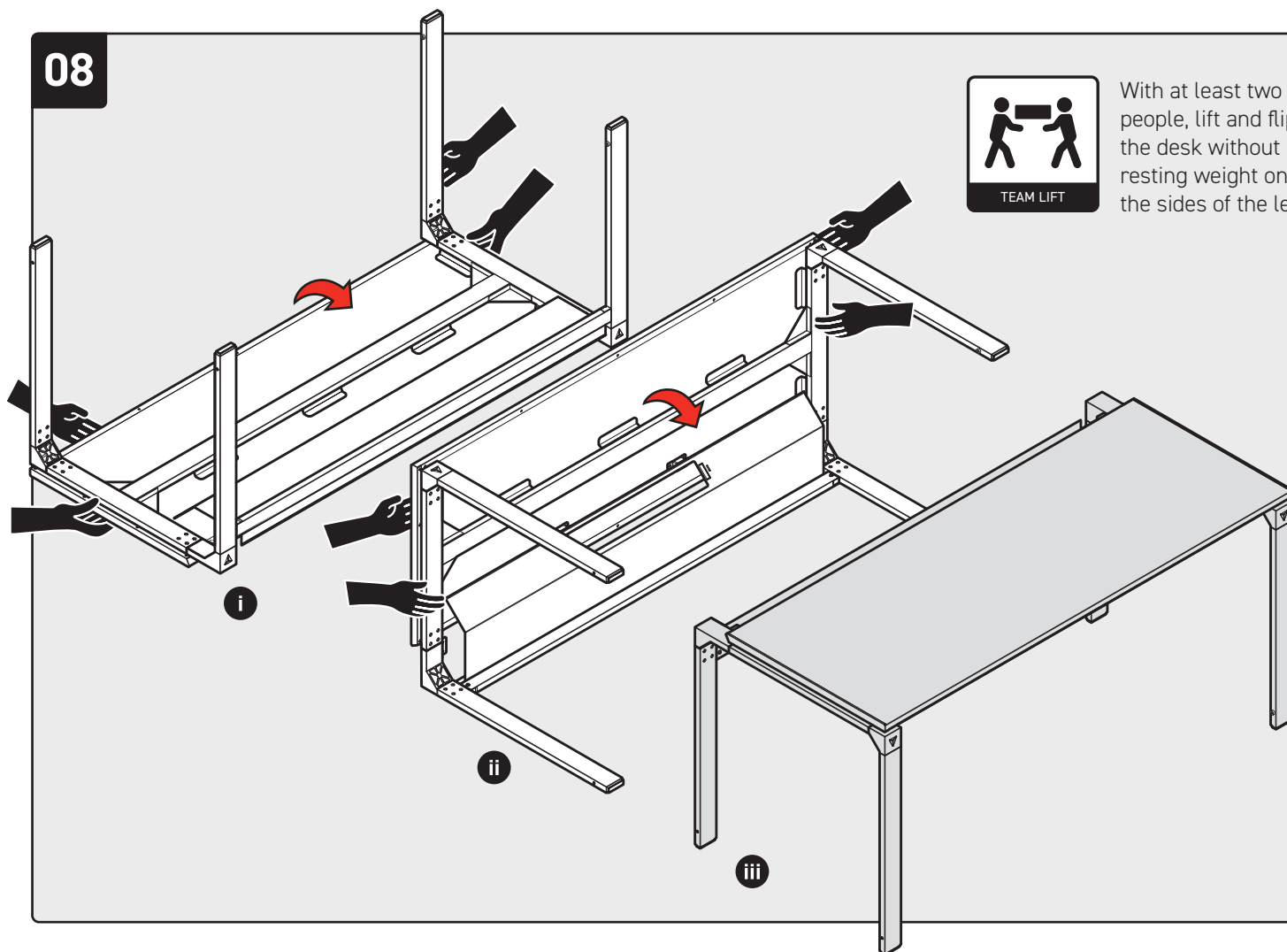

09



Pull both hinges down and align the **Hinged Rear Cover** onto the Secretlab MAGNUS. Screw in the fasteners.

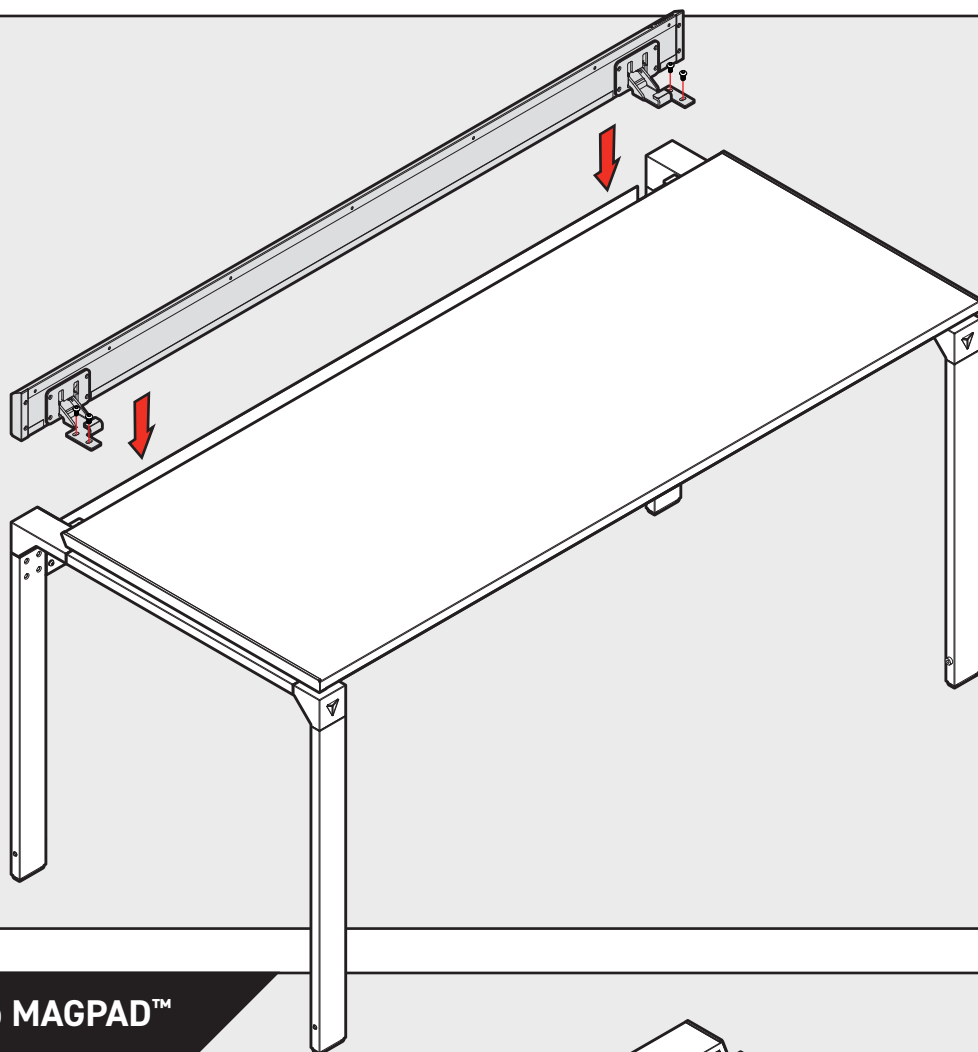
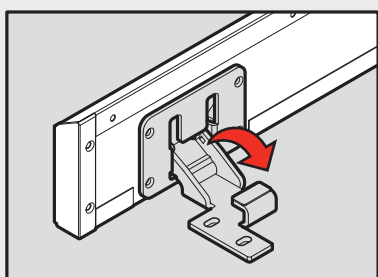

## 01 Installing the Secretlab MAGPAD™

Remove the **Metal Sleeves** from the inside of the rolled up **Secretlab MAGPAD**. Set them on the sides of the Secretlab MAGNUS. Unfasten the center strip.

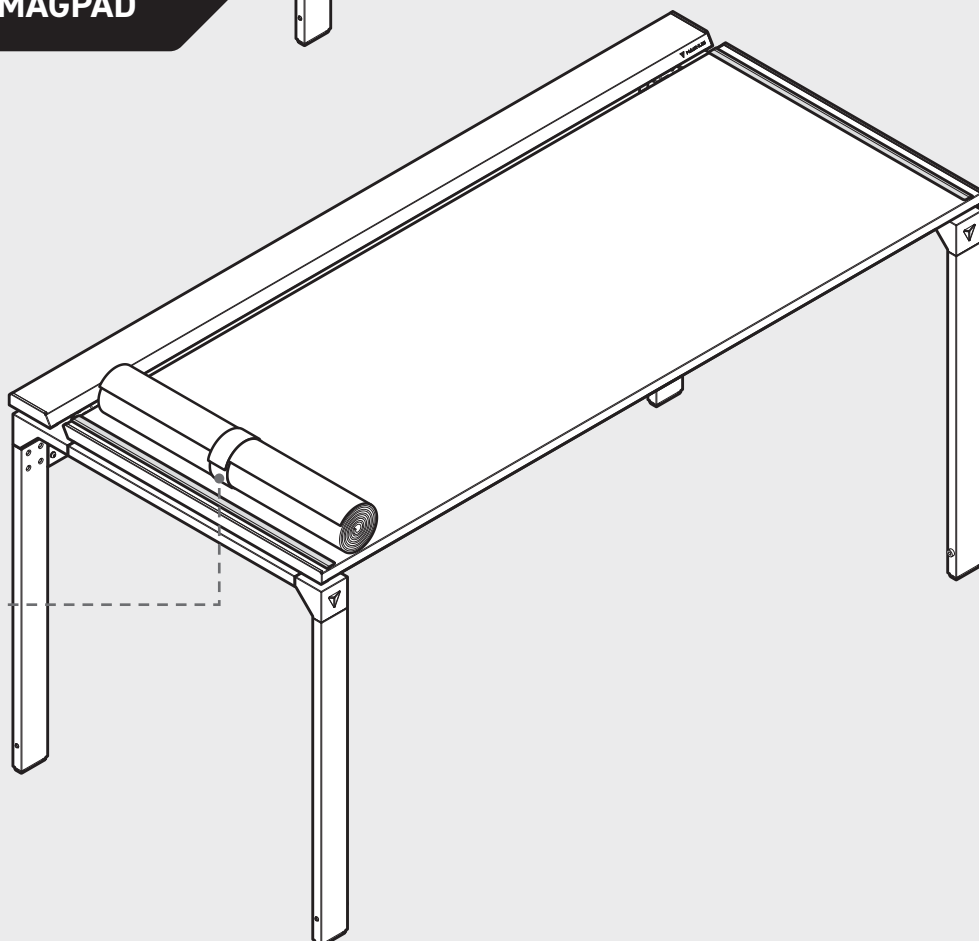
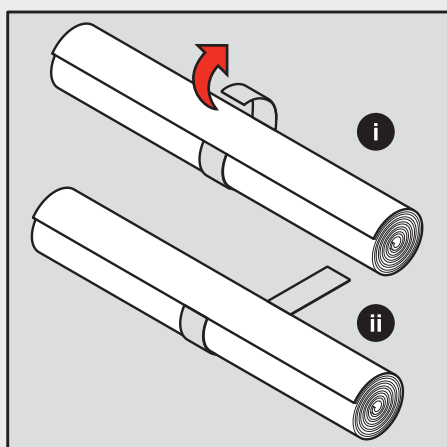

02

Slide the **Metal Sleeve** onto one end of the **Secretlab MAGPAD**. Ensure that the MAGPAD has been fully inserted into the sleeve. Check that the sleeve is flushed with the edge of your Secretlab MAGNUS.

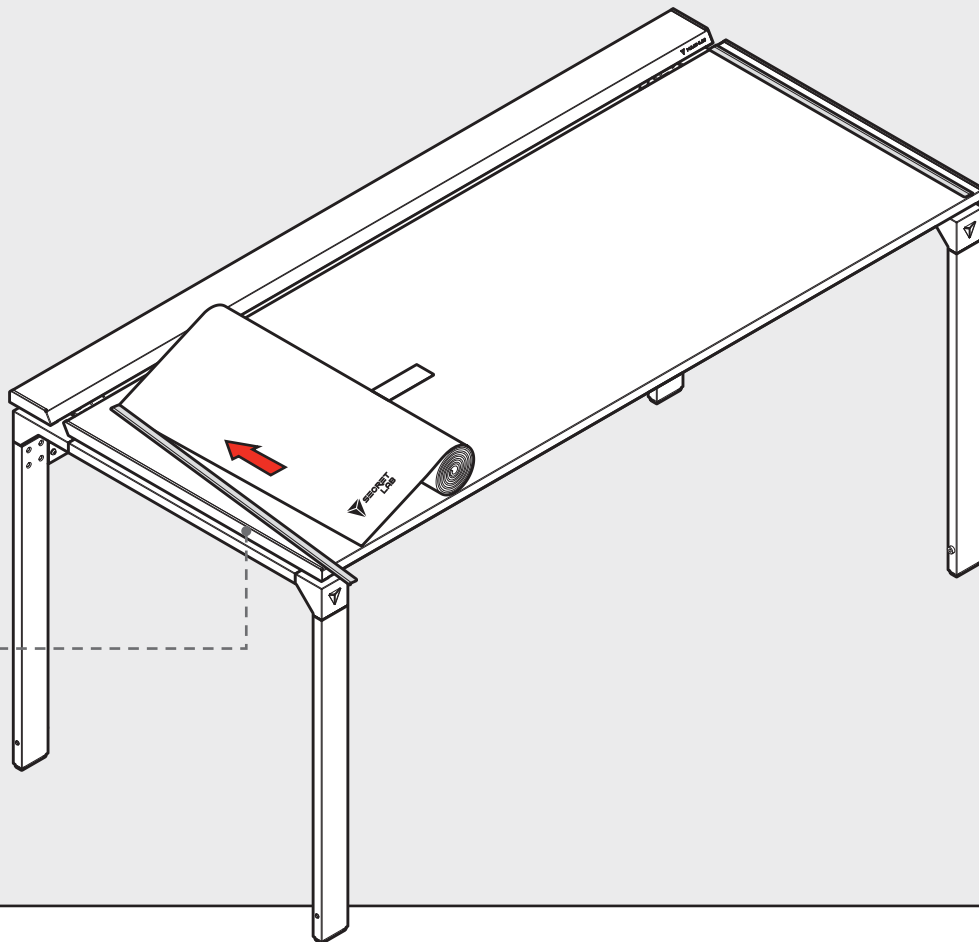
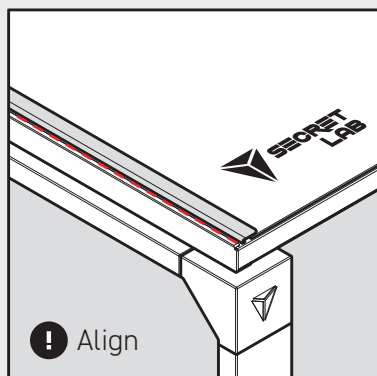

03

Pull the center strip to unroll the **Secretlab MAGPAD**. Take care to align the bottom edge of the desk mat with the Secretlab MAGNUS as you unroll it.

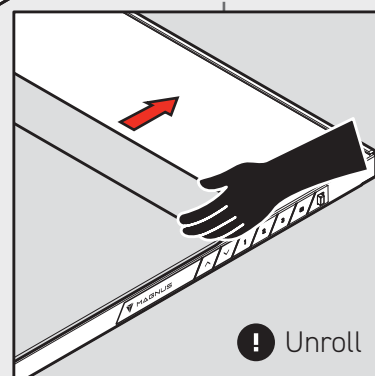
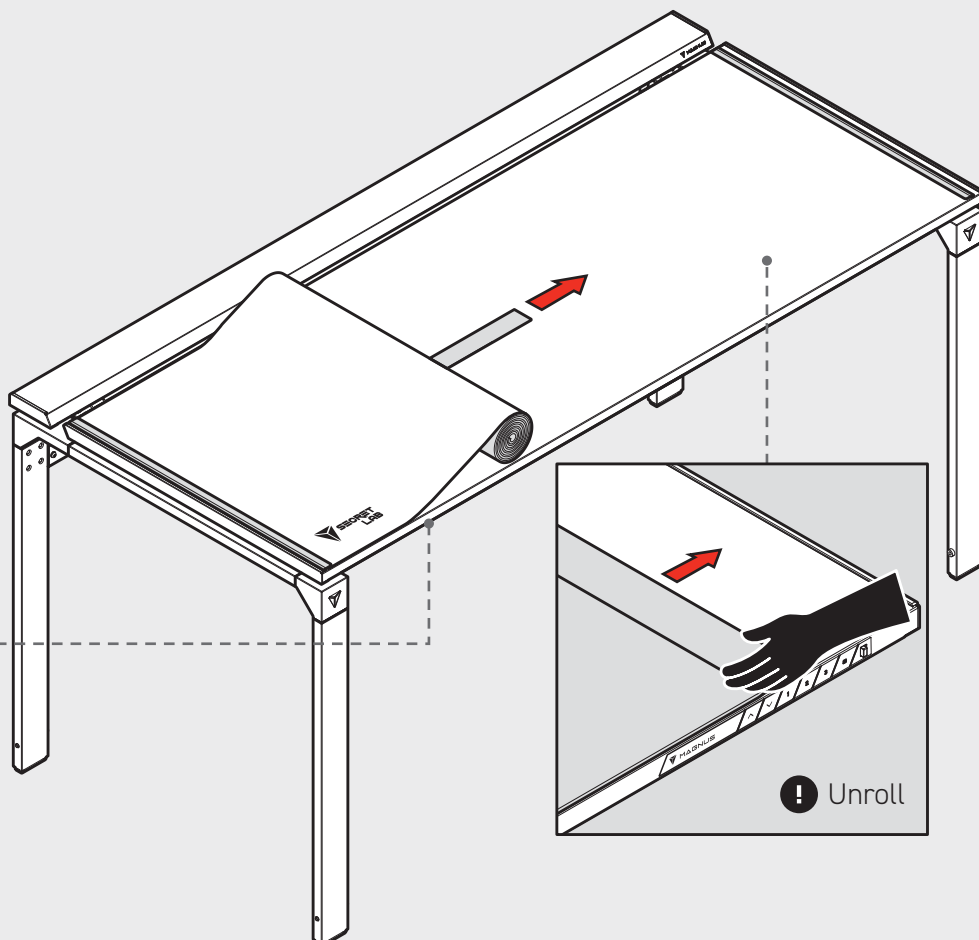
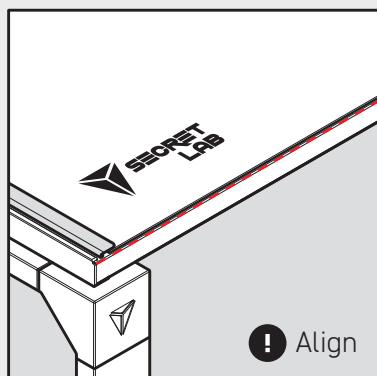

04

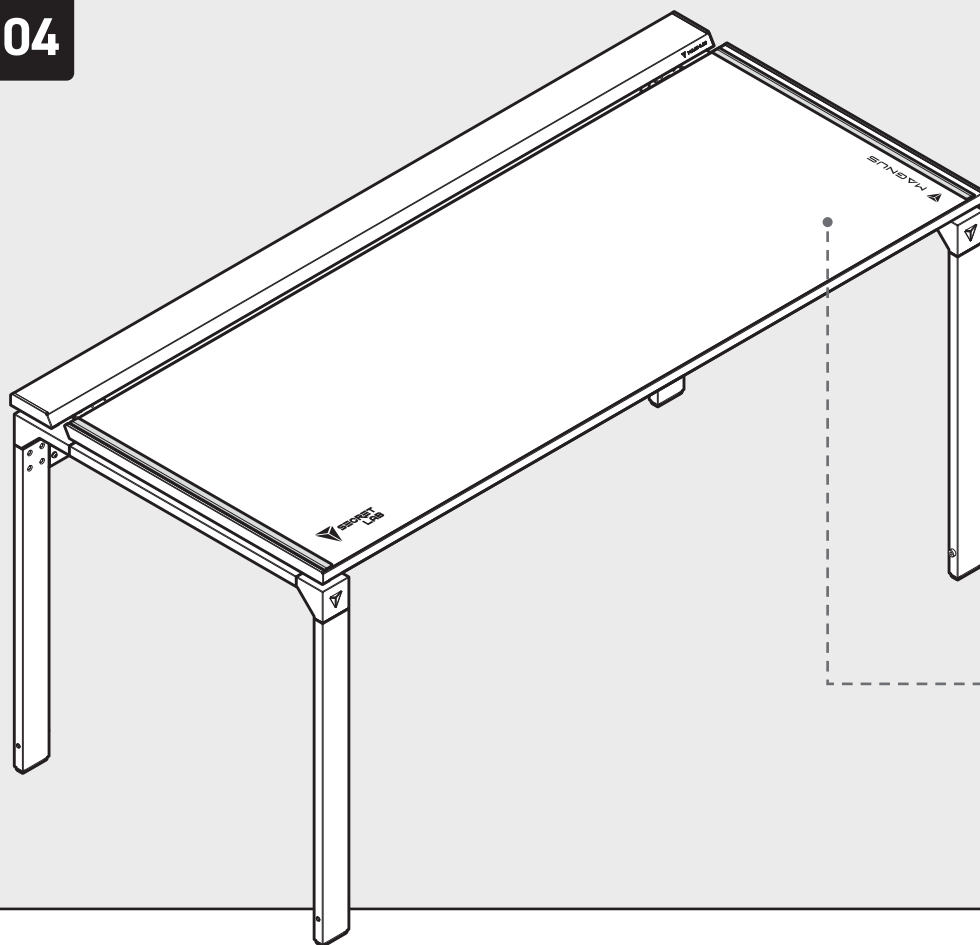

As with before, slide the second **Metal Sleeve** onto the **Secretlab MAGPAD**. Ensure that the MAGPAD has been fully inserted into the sleeve. Slide the **Metal Sleeve** up to the edge of the Secretlab MAGNUS. Adjust to cover any visible gap.

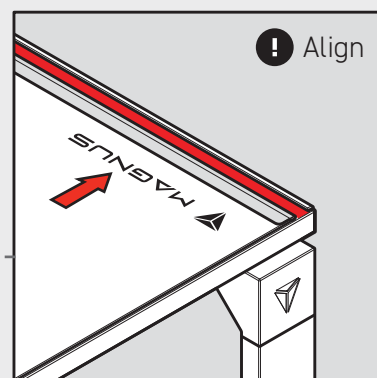

## Final Touches - Adjusting the Desk Height



Using the **Magnetic Screwdriver**, turn clockwise to increase the height and anti-clockwise to decrease the height. Do not adjust when there is heavy load on the desk.

Height Adjustment Range:  
**+20mm**

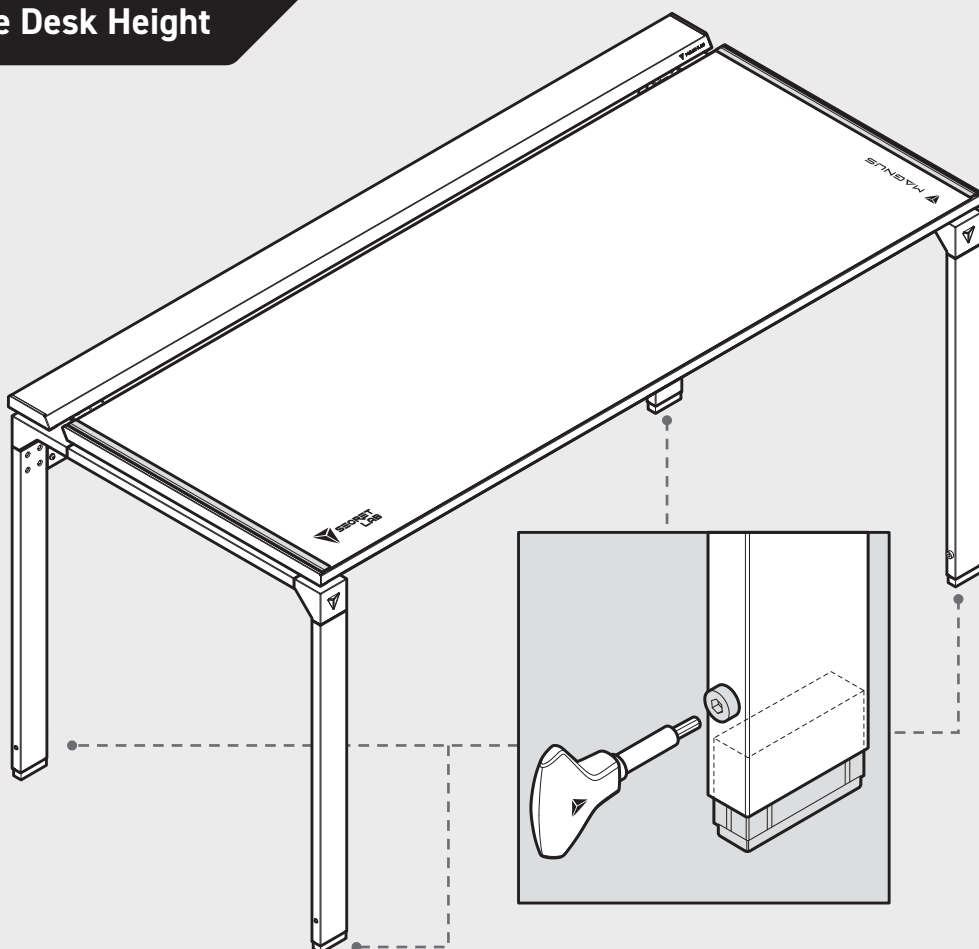

## USAGE INSTRUCTIONS

### Handling the Hinged Rear Cover



Always open and close the **Hinged Rear Cover** from the sides. Do not open and close the cover via the middle of the desk and keep hands and fingers clear of this area.

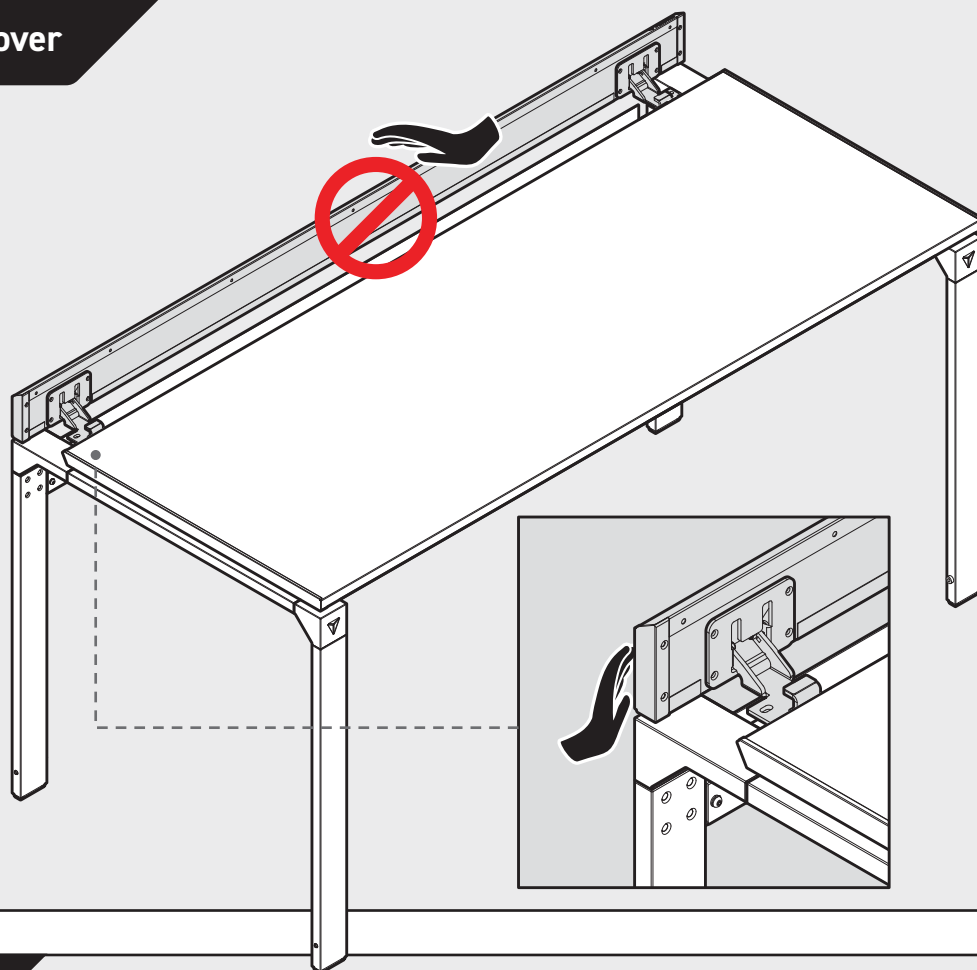

### Mounting a Monitor Arm

If you plan on using a monitor arm with the Secretlab MAGNUS, we recommend it to be mounted within the midsection of the desk. It will be easier to access the monitor arm hardware through the front of the **Passthrough Cover** from underneath the desk.

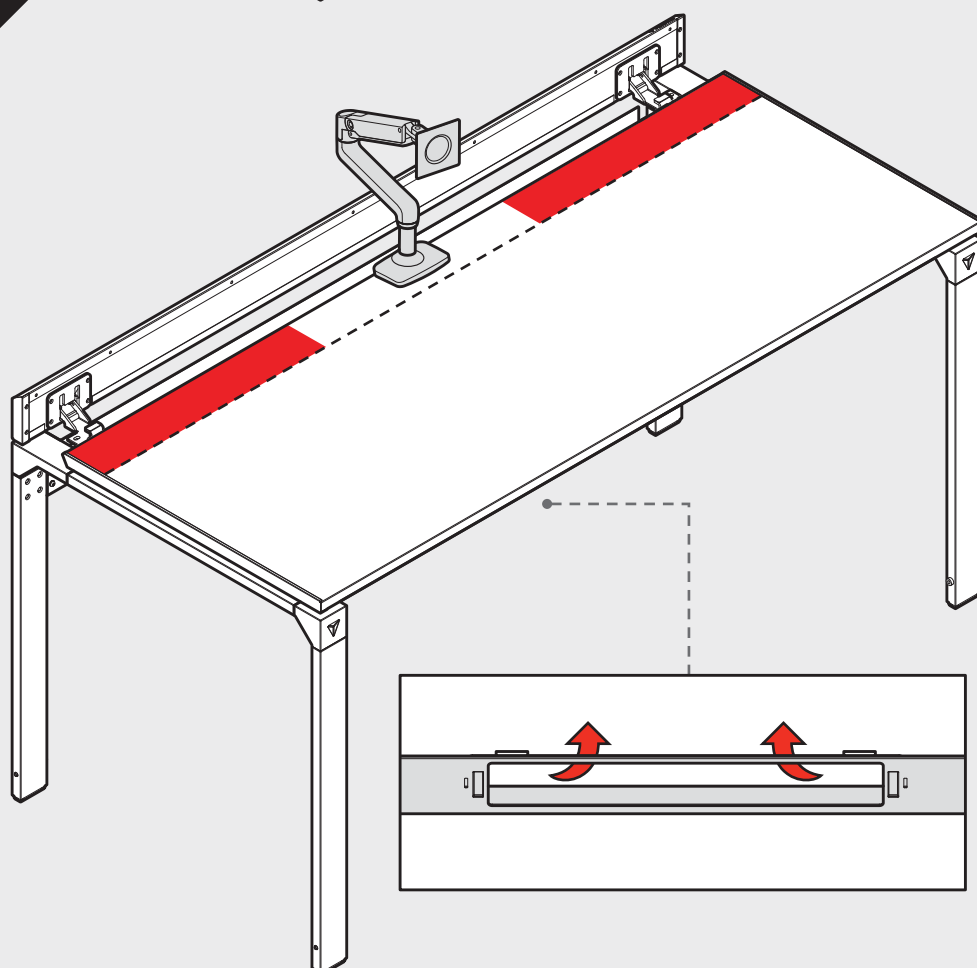

## USAGE INSTRUCTIONS

### Mounting the Tray Passthrough Cover

Place the **Passthrough Cover** back onto the **Cable Tray** and the Secretlab MAGNUS Metal Desk is now ready for your long hours of work or play!

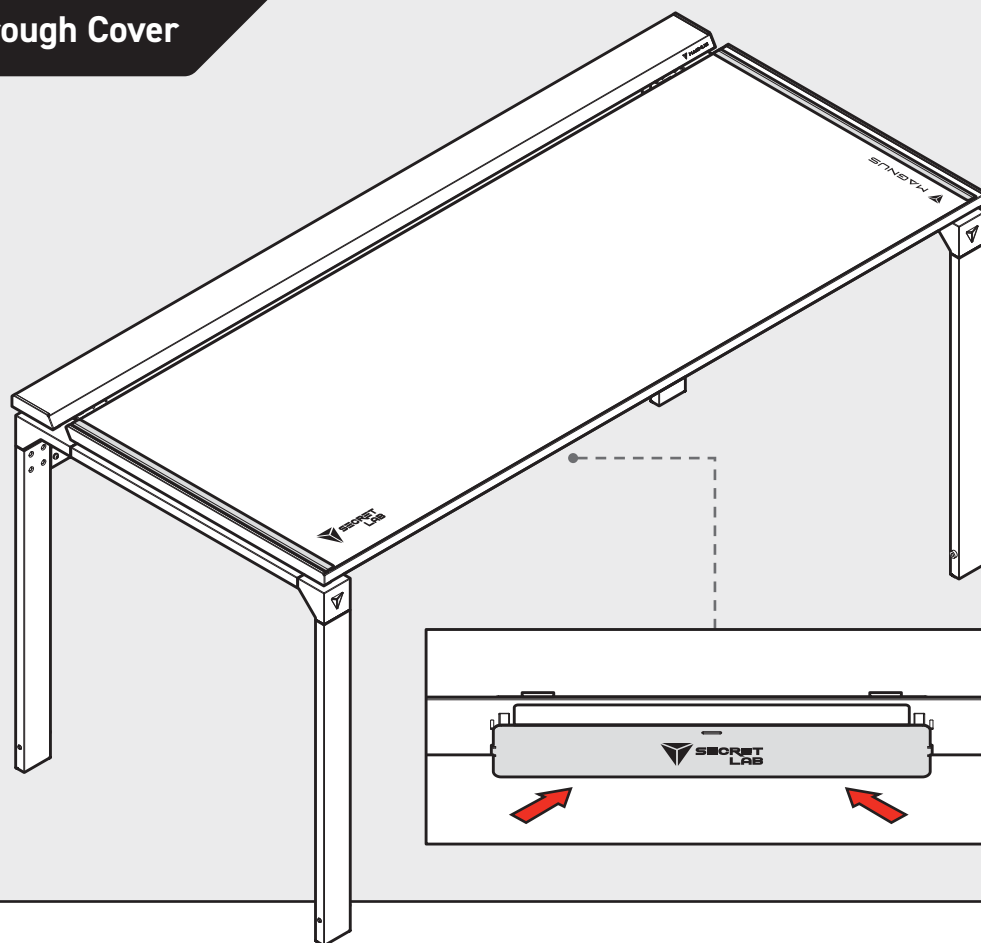

## DISPOSAL OF YOUR OLD PRODUCT



Please find out about your local collection system for the product. The correct disposal of your old product will help to prevent potential negative consequences for the environment and human health.



Secretlab, the Secretlab logo and the Triangle logo are registered trade marks of Secretlab.  
Magnus is a registered trade mark of Secretlab in Singapore, New Zealand and the Phillipines.  
The Magnus logo is a registered trade mark of Secretlab in the EU.