

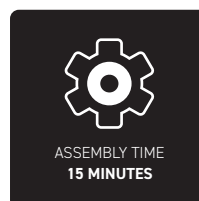

Assembly Guide and **User Manual**

Secretlab L-Shaped Desk Extension

(For Secretlab MAGNUS Original Version)

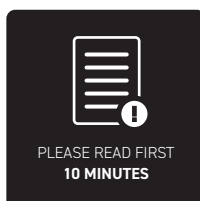

CONTENTS

Warnings and Caution	1
Use and Liability	1
Usage and Safety Instructions	1
Technical Specifications	2
What's In the Box	3
Assembly Tool Kit	3
Preface	4
Installation Guide	5
Preparing your MAGNUS Desk	5
Assembling the Desk Extension	7
Installing the Desk Extension to your MAGNUS	10
Usage Instructions	13
Secretlab MAGPAD™ Desk Mat	13
Mounting Monitor Arm	13
Cable Management	14
Hinged Rear Cover	14

IMPORTANT SAFETY INSTRUCTIONS



PLEASE READ PRIOR TO INSTALLATION

This user manual contains important safety regulations. Any non-conforming use may result in personal injury or mechanical damage. Please read this user manual carefully before use as it provides key information about safety, use, assembly and maintenance of the Secretlab L-Shaped Desk Extension.

Ensure that you have received all parts according to the part checklist prior to installation. If any parts are missing or faulty, contact the Secretlab support team for replacements. The Secretlab L-Shaped Desk Extension is to be assembled by at least two people. This product contains small items that could be a choking hazard if swallowed. Keep these items away from children and pets. Do not overtighten the screws during installation.

Do not exceed the maximum load capacity of the extension table top (100kg). Do not wobble the desk extension forcefully on purpose. The Secretlab L-Shaped Desk Extension is designed for indoor use only. Using the product outdoors could lead to product failure and personal injury. Place the desk extension away from corrosive gas, water and dusty environment. Alteration or modding of any factory components outlined in the part checklist will automatically void your warranty.

USE AND LIABILITY



The Secretlab L-Shaped Desk Extension is designed for indoor use and dry work areas only. Under no circumstances does the manufacturer accept warranty claims or liability claims for damages caused from improper use or handling of the extension desk. For warranty terms and service or any other queries, scan the QR code or visit our website secretlab.co/support.

USAGE AND SAFETY INSTRUCTIONS



This desk is not intended for use by children without adult supervision.



Do not stand on the desk.



Do not exceed the maximum load capacity stated for the table top and rear cover.



Do not sit on the desk.

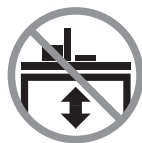

Do not adjust the desk height when there is heavy load on top.



Do not drag the desk across the floor.



Do not use the desk as a cutting surface.



Do not place your hand or fingers between the rear cover and table top.

TECHNICAL SPECIFICATIONS

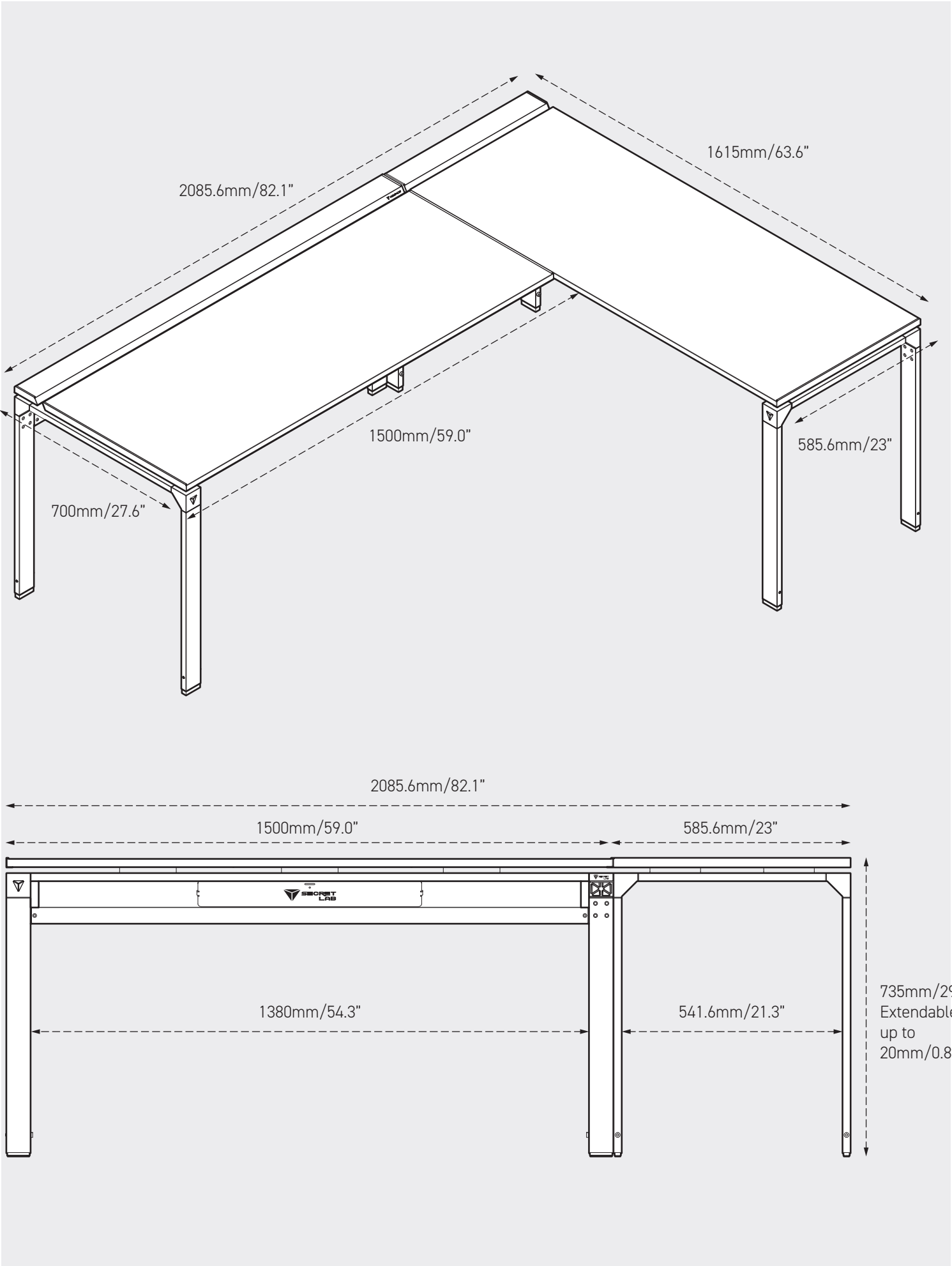

WHAT'S IN THE BOX

- | | |
|--|-----------|
| 1. Secretlab L-Shaped Desk Extension Hinged Rear Cover | X1 |
| 2. Secretlab L-Shaped Desk Extension Table Top | X1 |
| 3. Secretlab L-Shaped Desk Extension Table Leg | X3 |
| 4. Connecting Bracket | X1 |

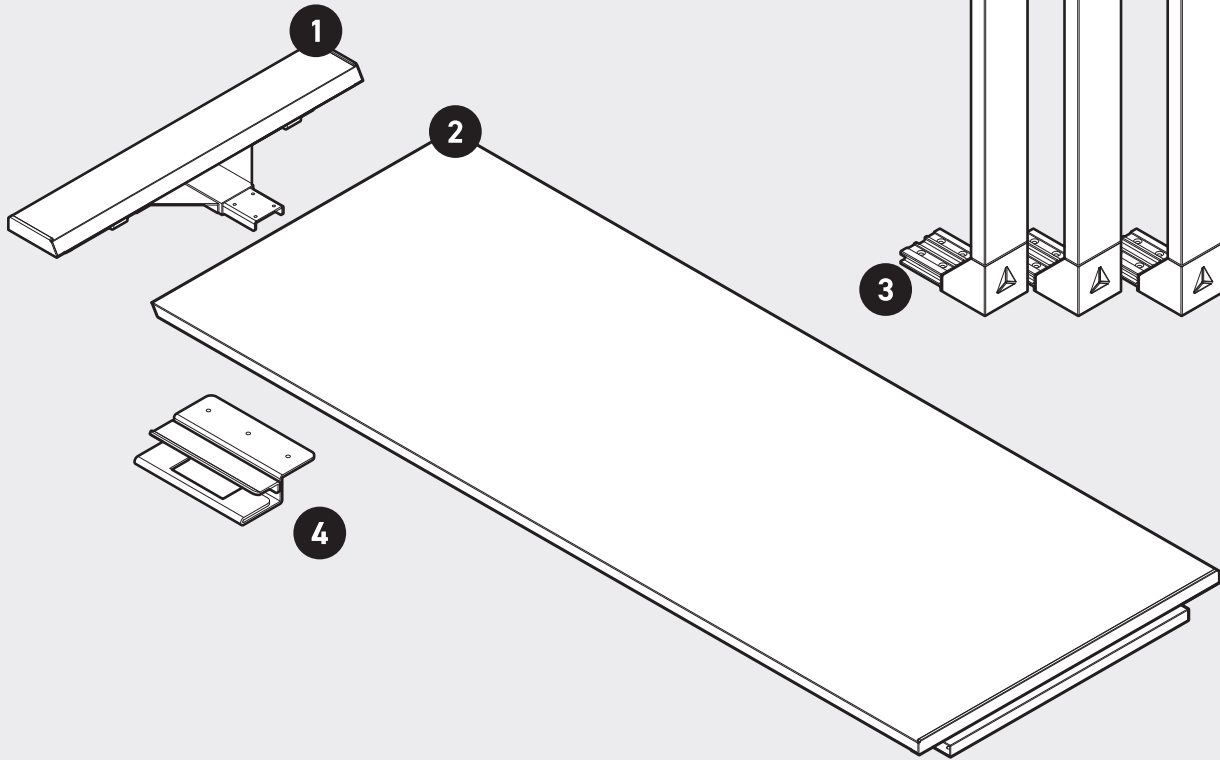

ASSEMBLY TOOL KIT

- | | |
|---------------------------------------|------------|
| 5. Magnetic Screwdriver Handle | X1 |
| 6. Reversible Philips + Hex Screw Bit | X1 |
| 7. M5 Height Adjustment Allen Key | X1 |
| 8. M3 Main Allen Key | X1 |
| 9. Finishing Cap | X1 |
| 10. M5x18 Long Pan Head Screw | X4 |
| 11. M5x12 Short Pan Head Screw | X3 |
| 12. M5x16 Flat Head Screw | X16 |

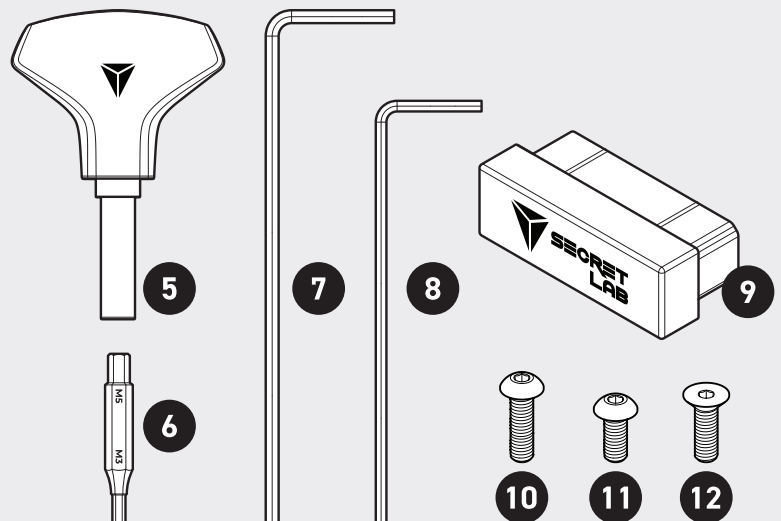

PREFACE



PLEASE READ PRIOR TO INSTALLATION

The Secretlab L-Shaped Desk Extension is reversible and can be installed on either side of the Secretlab MAGNUS Desk. The diagram below shows all the possible configuration. Before assembly, consider the desired configuration and where you want your desk to be located. If you wish to install a monitor arm to your L-Shaped Desk Extension, refer to the Usage Instructions at **page 18**.

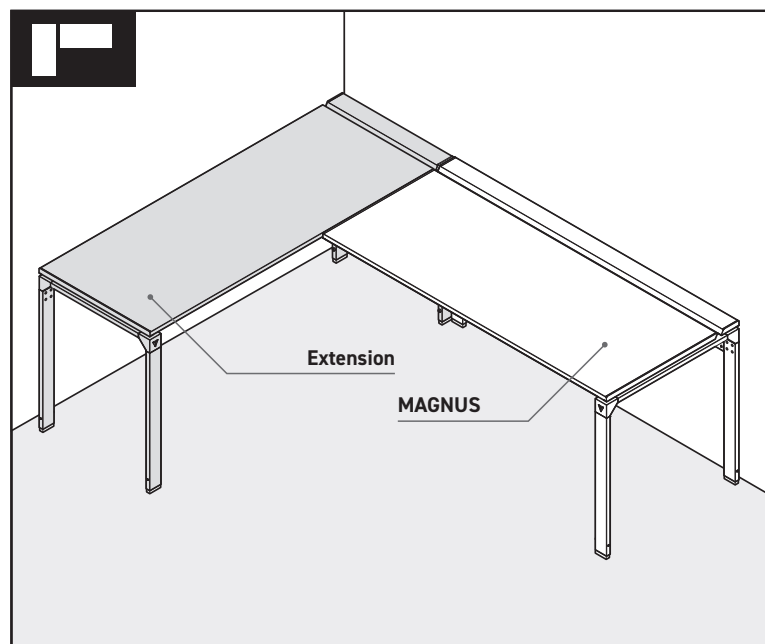

Left Desk Extension with Desk Extension in the Corner

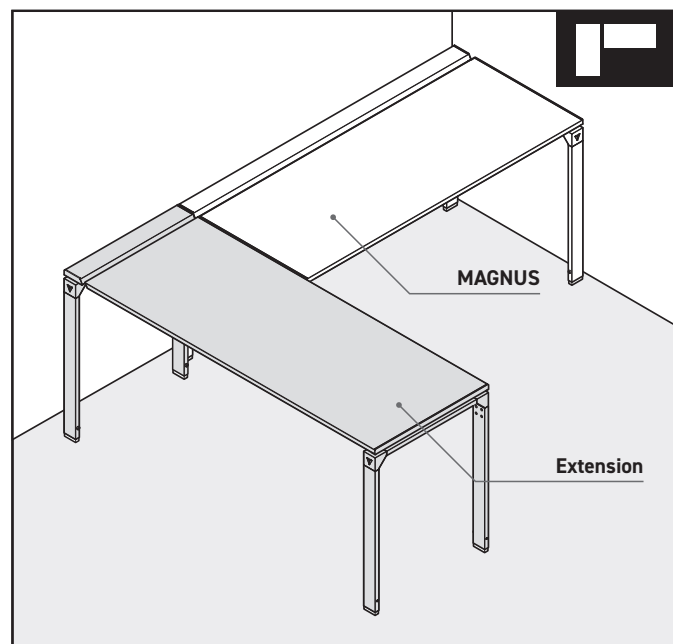

Left Desk Extension with MAGNUS Desk in the Corner

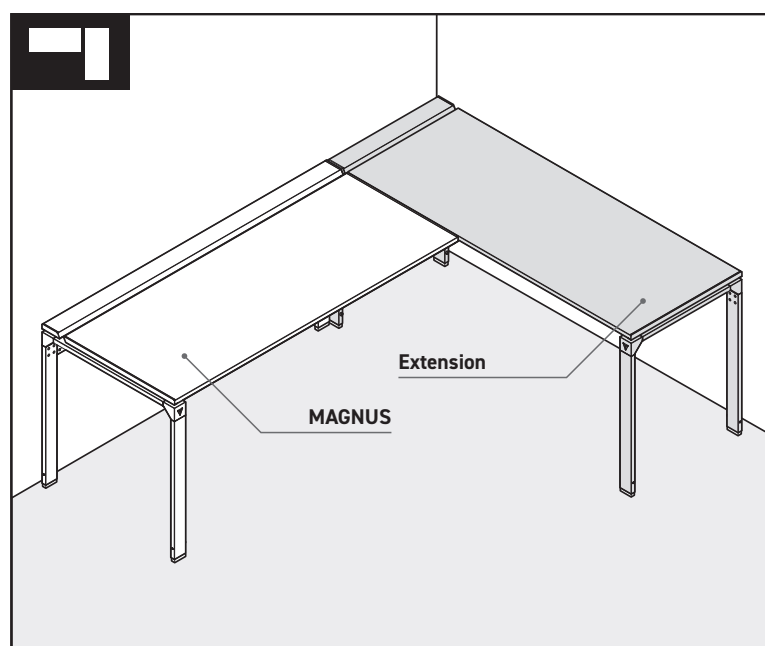

Right Desk Extension with Desk Extension in the Corner

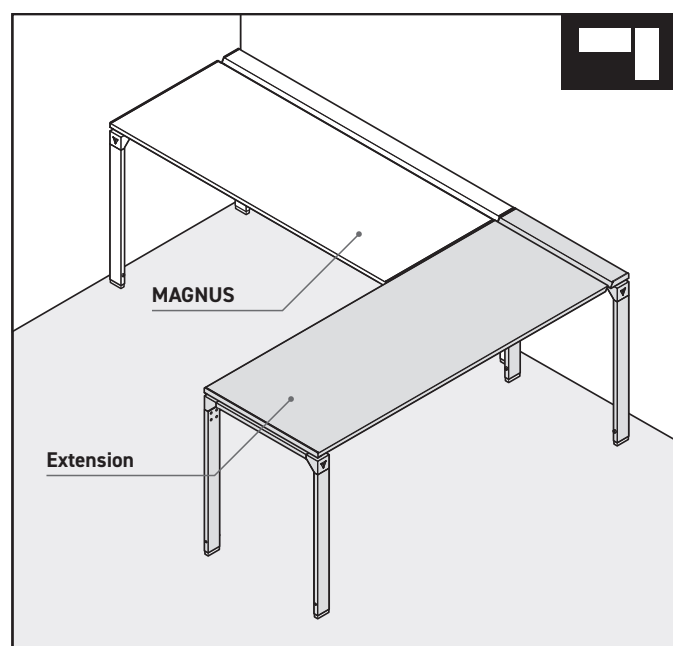

Right Desk Extension with MAGNUS Desk in the Corner

01

PREPARING YOUR MAGNUS DESK



Before you proceed, remove all contents from the L-Shaped Desk Extension packaging box and ensure that you have received all parts.

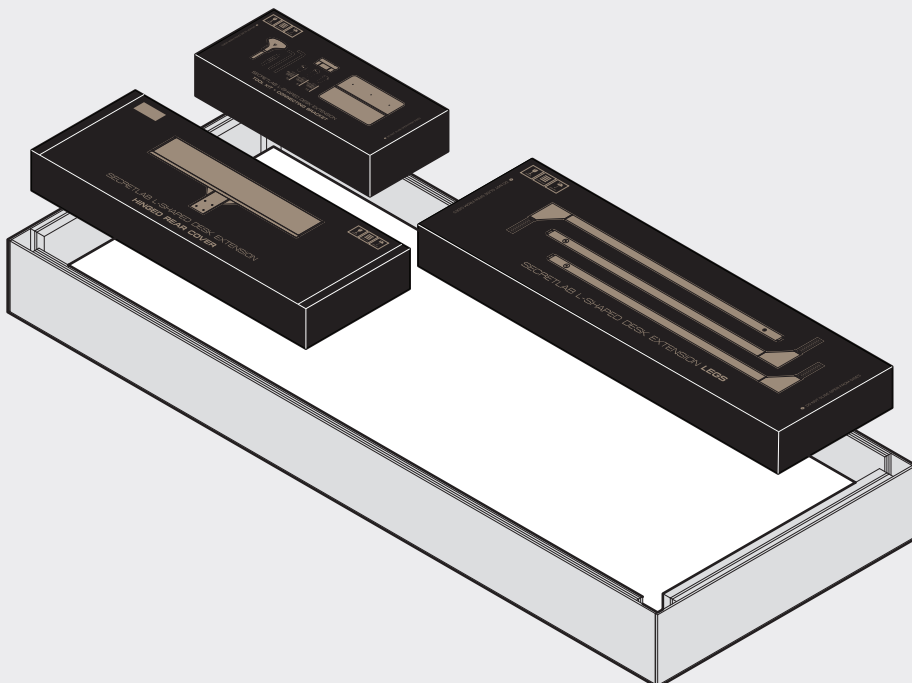

02

Using the larger height adjustment Allen key, turn anti-clockwise to reduce the height to the minimum. Ensure that all legs are adjusted to the minimum height.

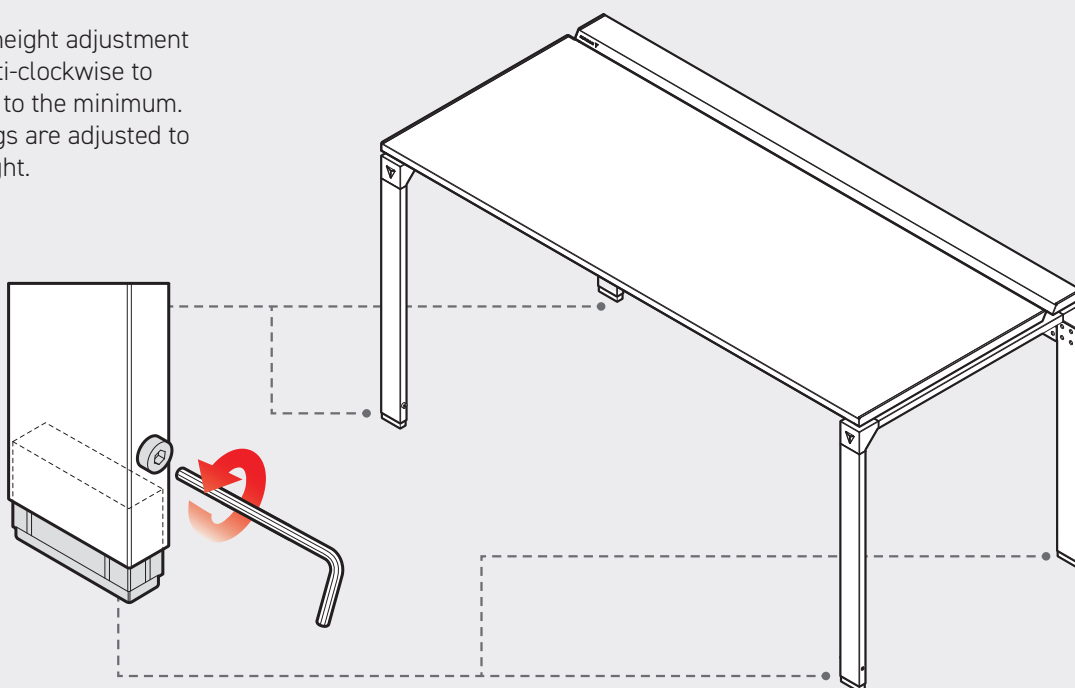

03

LEFT OR RIGHT

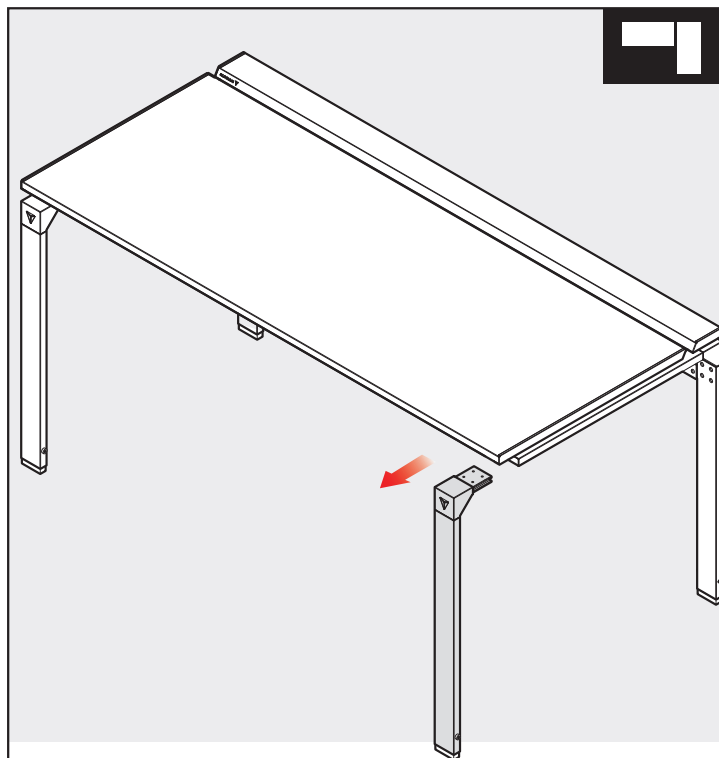
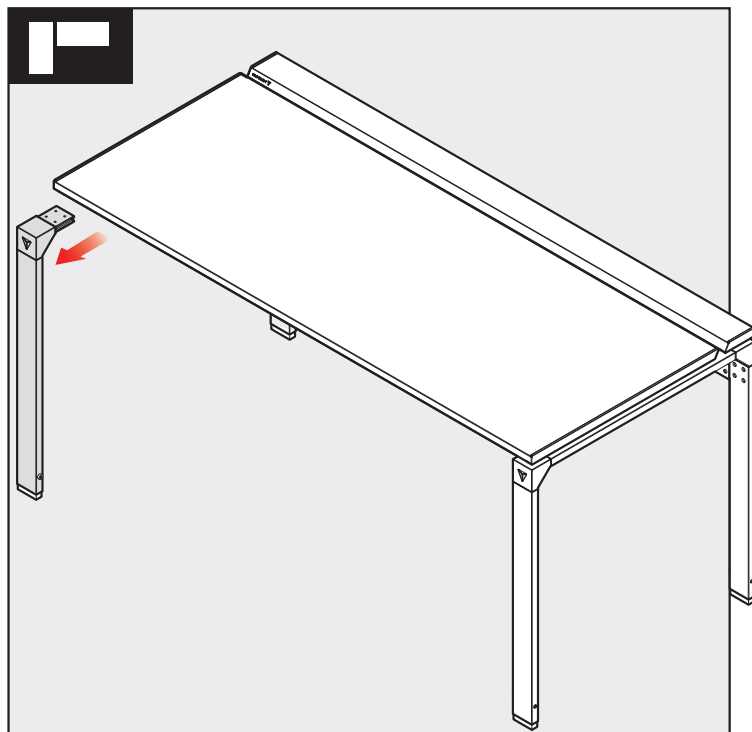

04

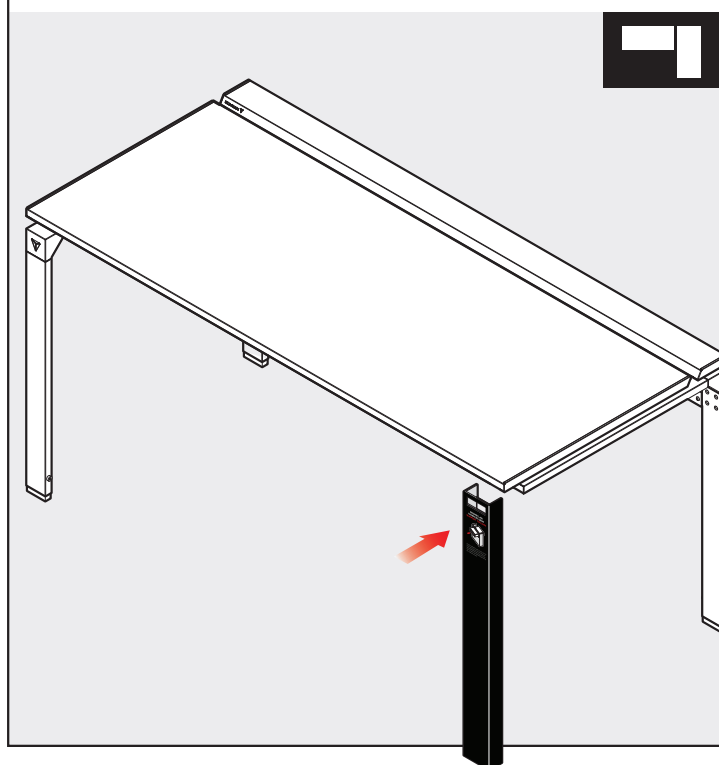
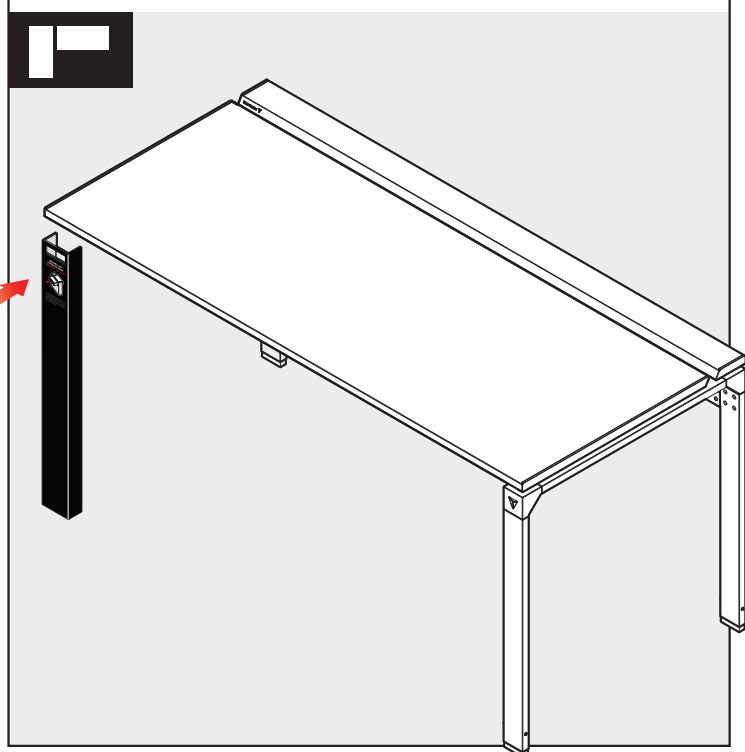

05

LEFT OR RIGHT

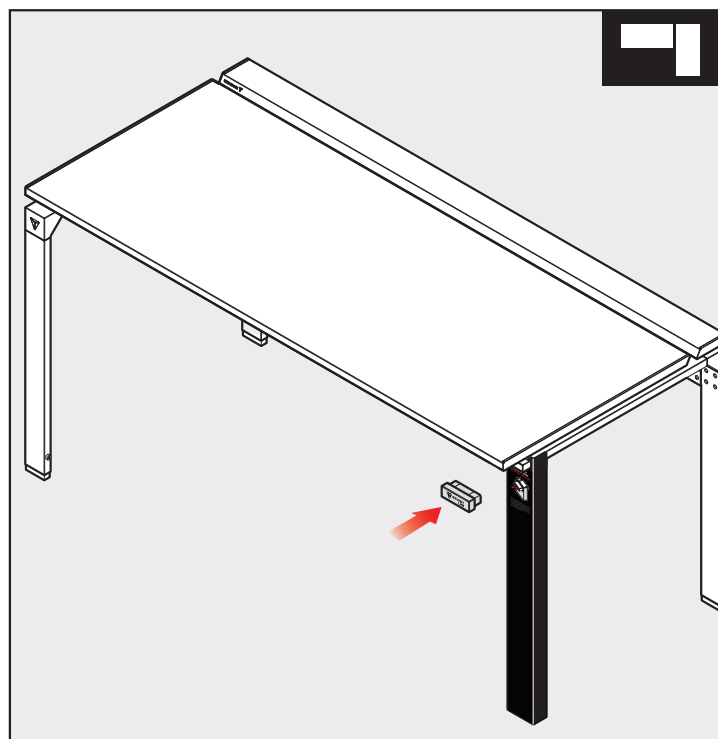
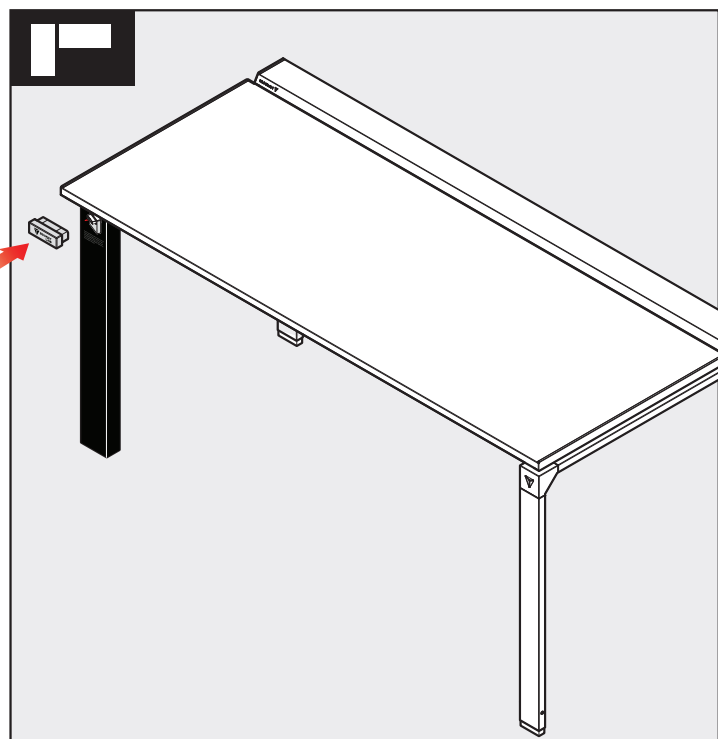

01

ASSEMBLING THE DESK EXTENSION



With at least two people, lift the extension table top and place it upside down onto the packaging box cover to protect the surface.

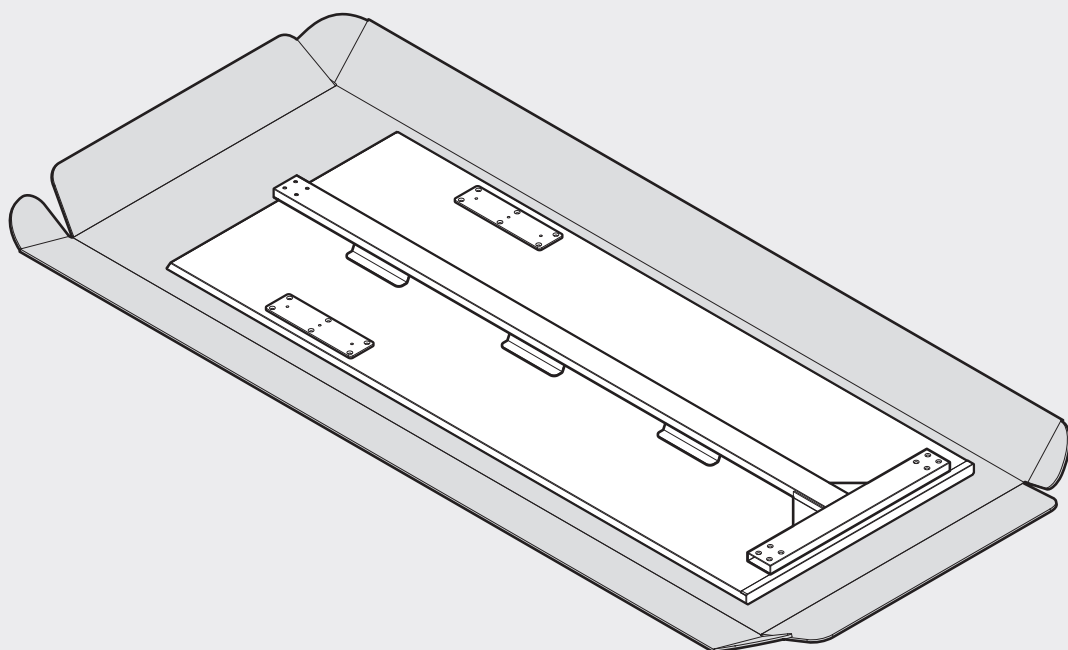

02

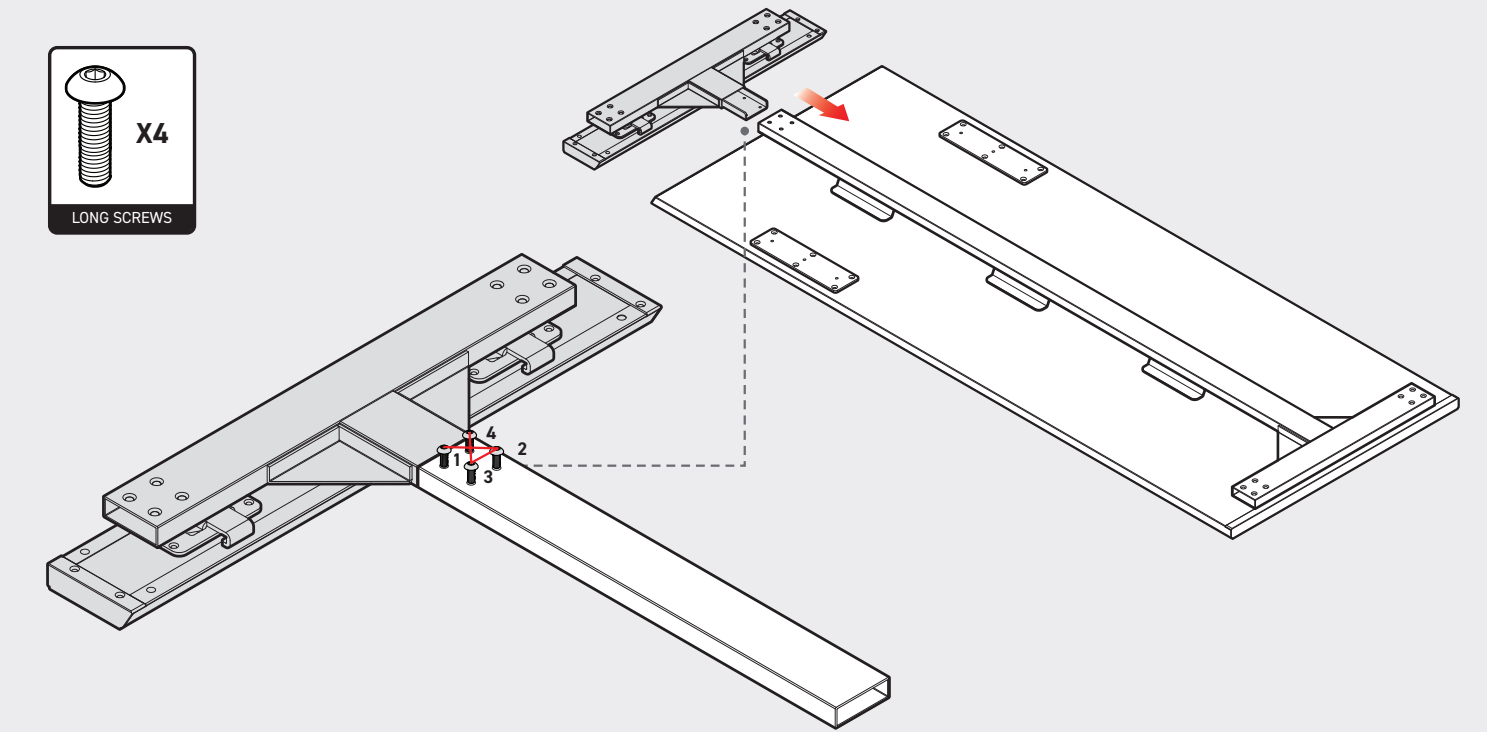

03

LEFT OR RIGHT

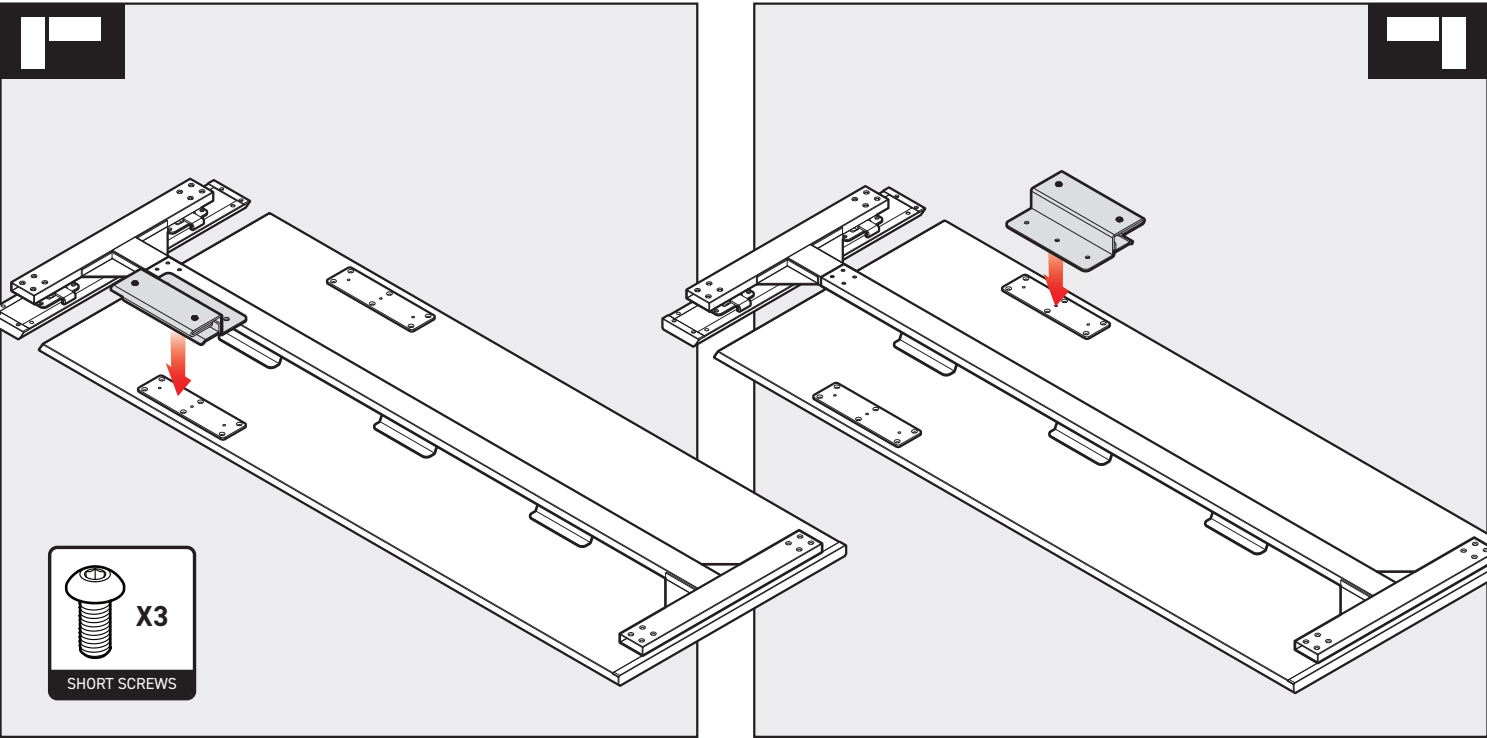

04

LEFT OR RIGHT

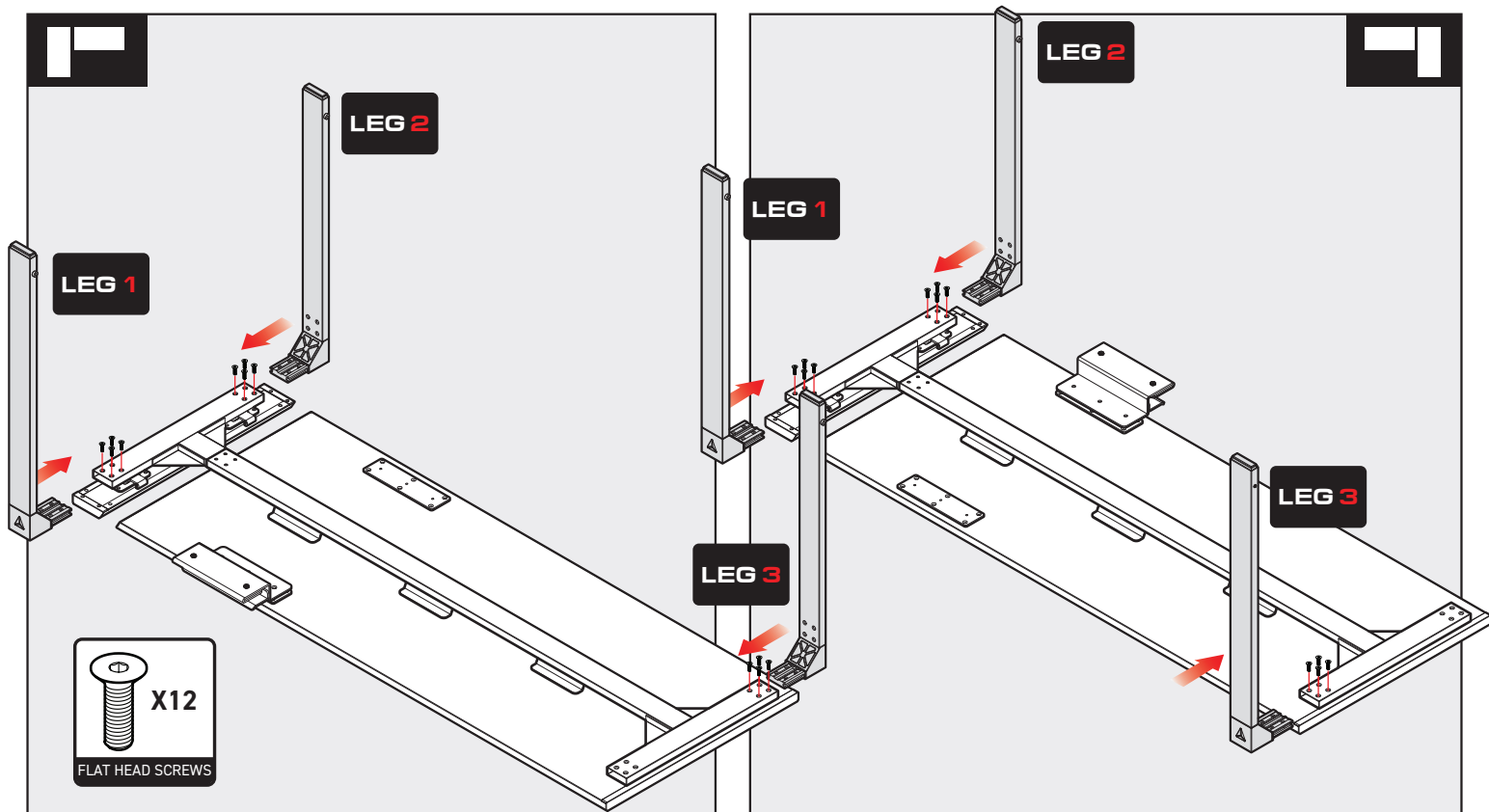

05

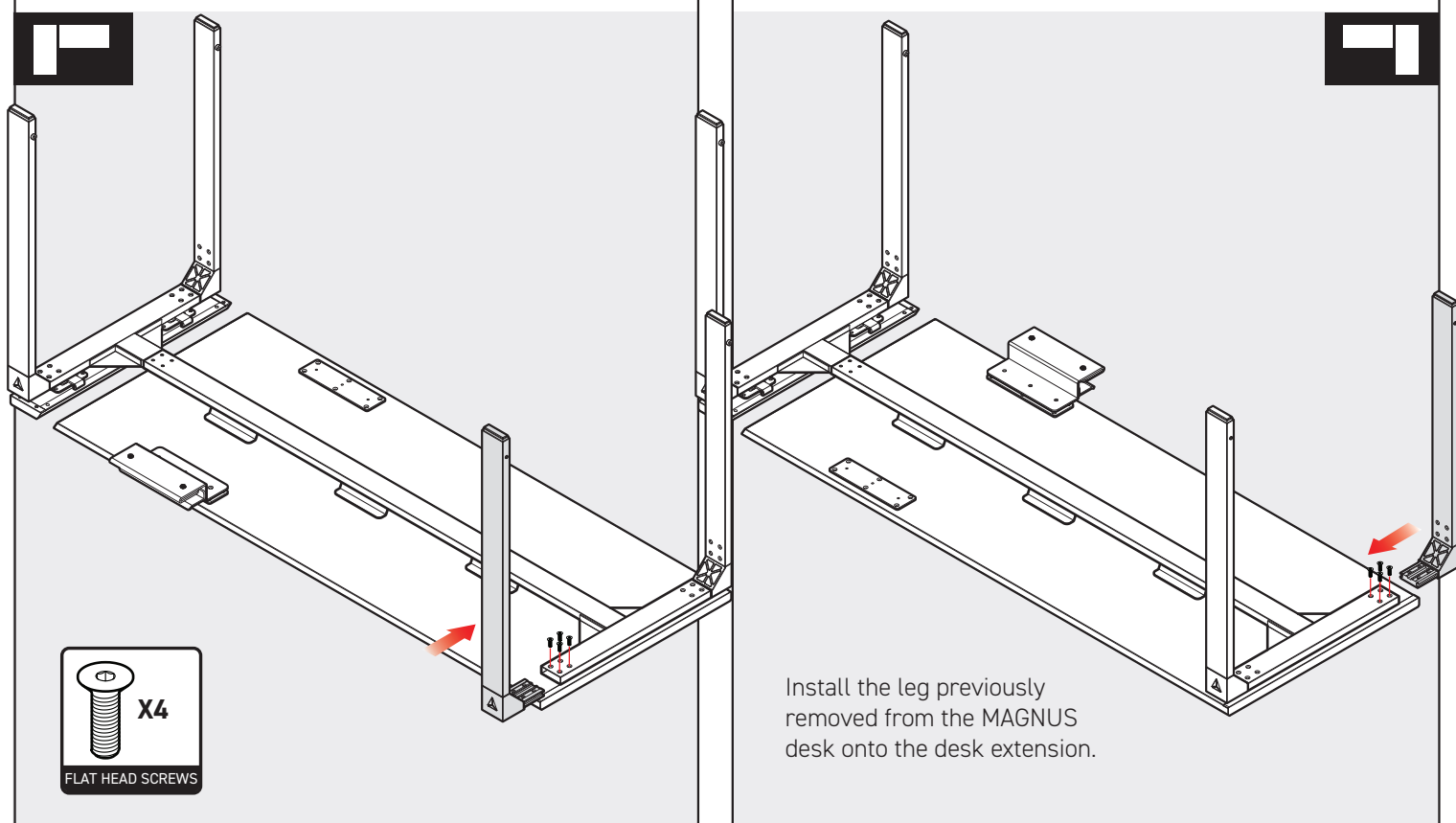

01

INSTALLING THE DESK EXTENSION TO YOUR MAGNUS

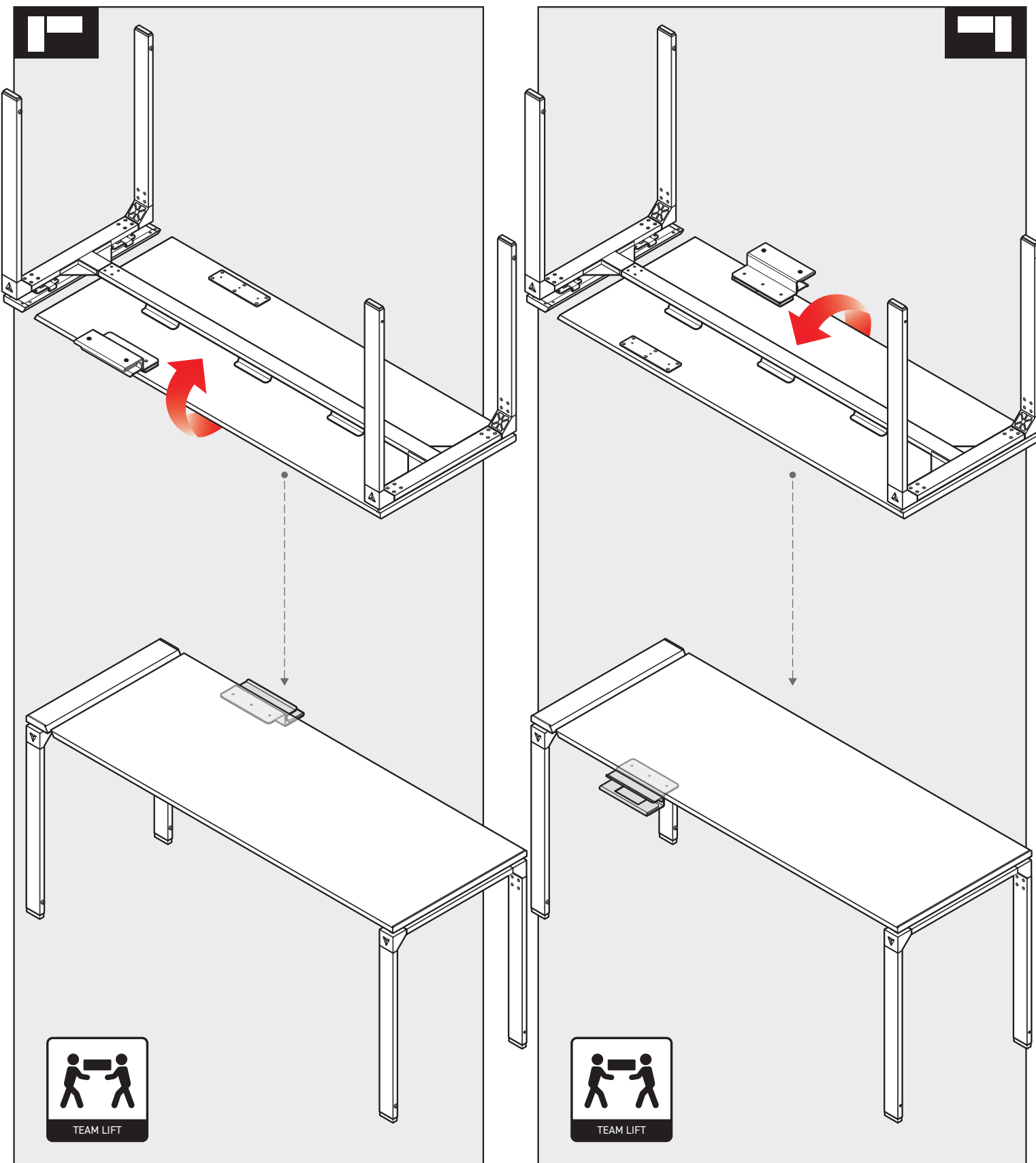

LEFT OR RIGHT

02

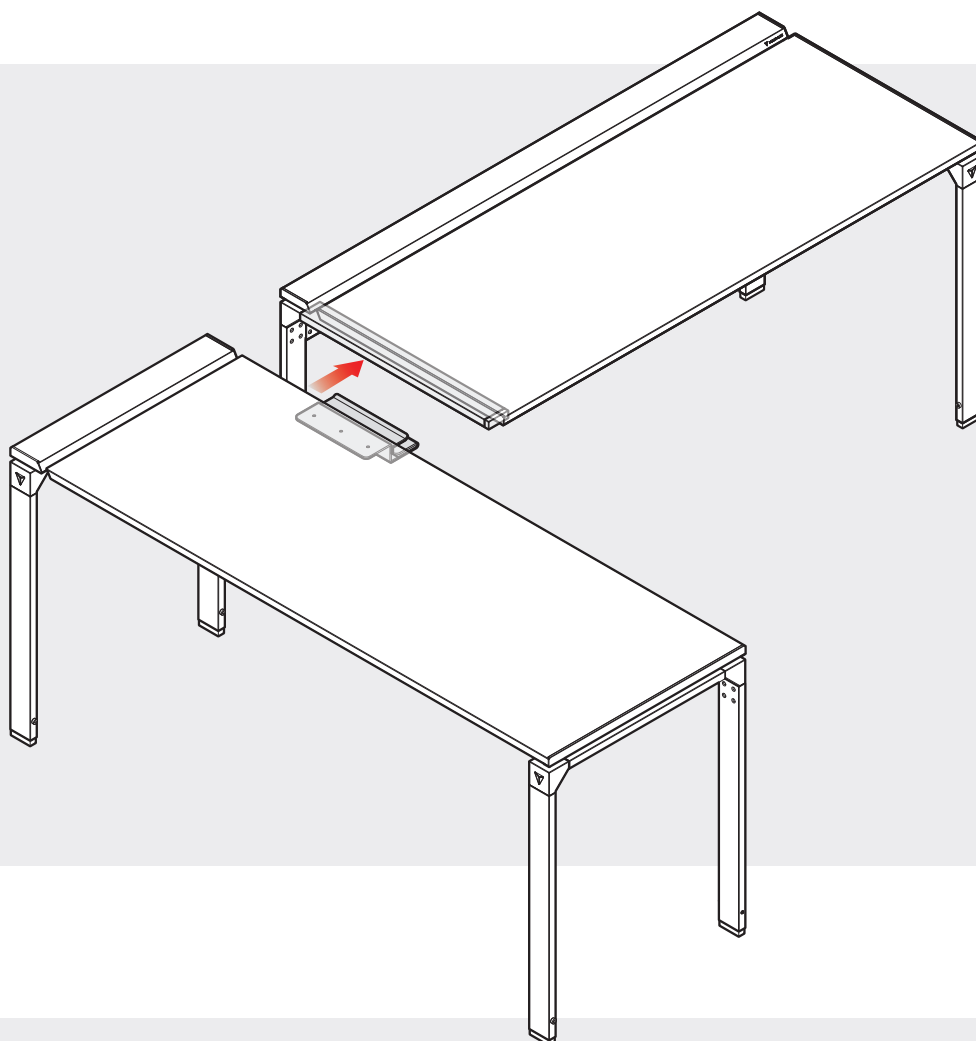

03

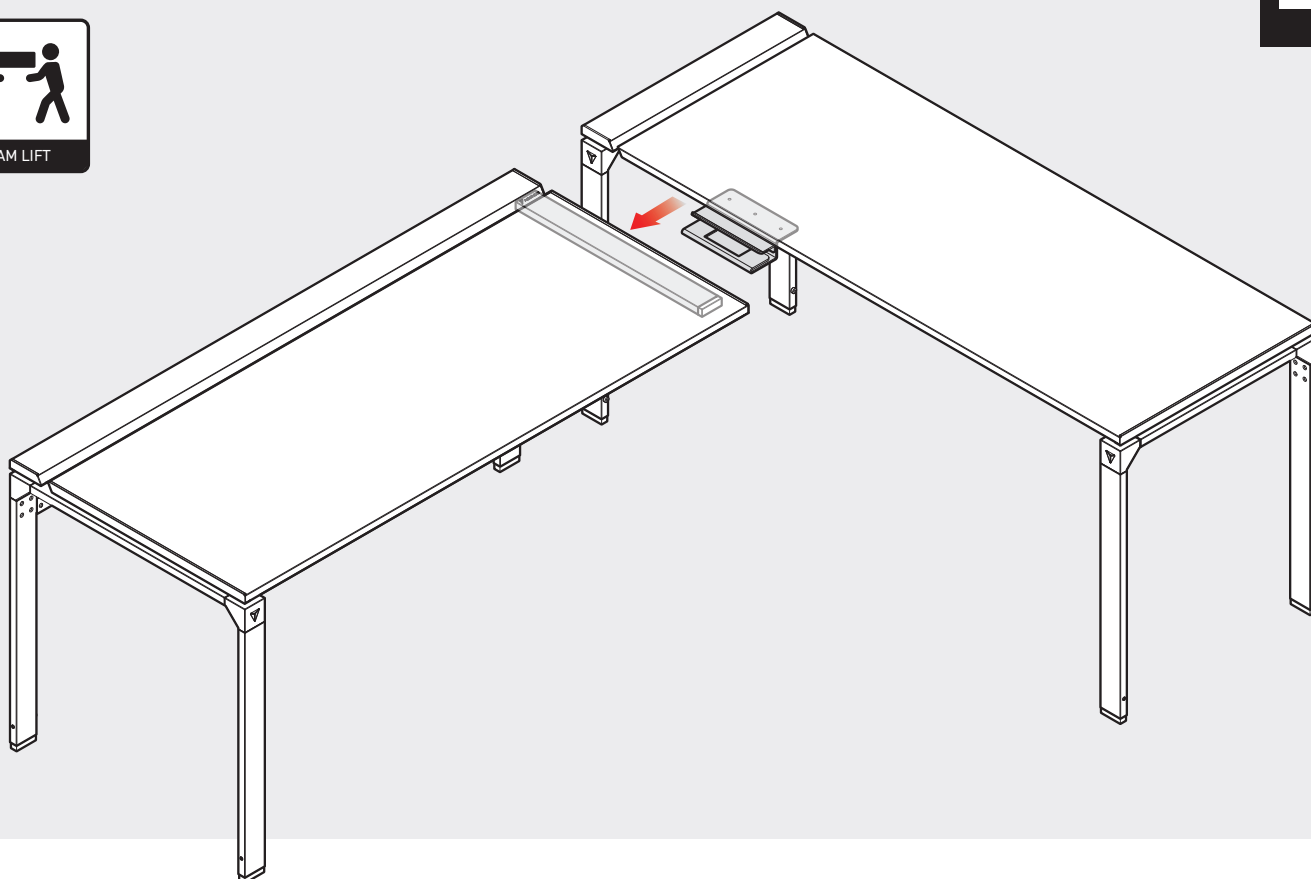

04



Align the desk extension to the MAGNUS desk by adjusting it in all four directions, ensuring that there is little to no gap between them.

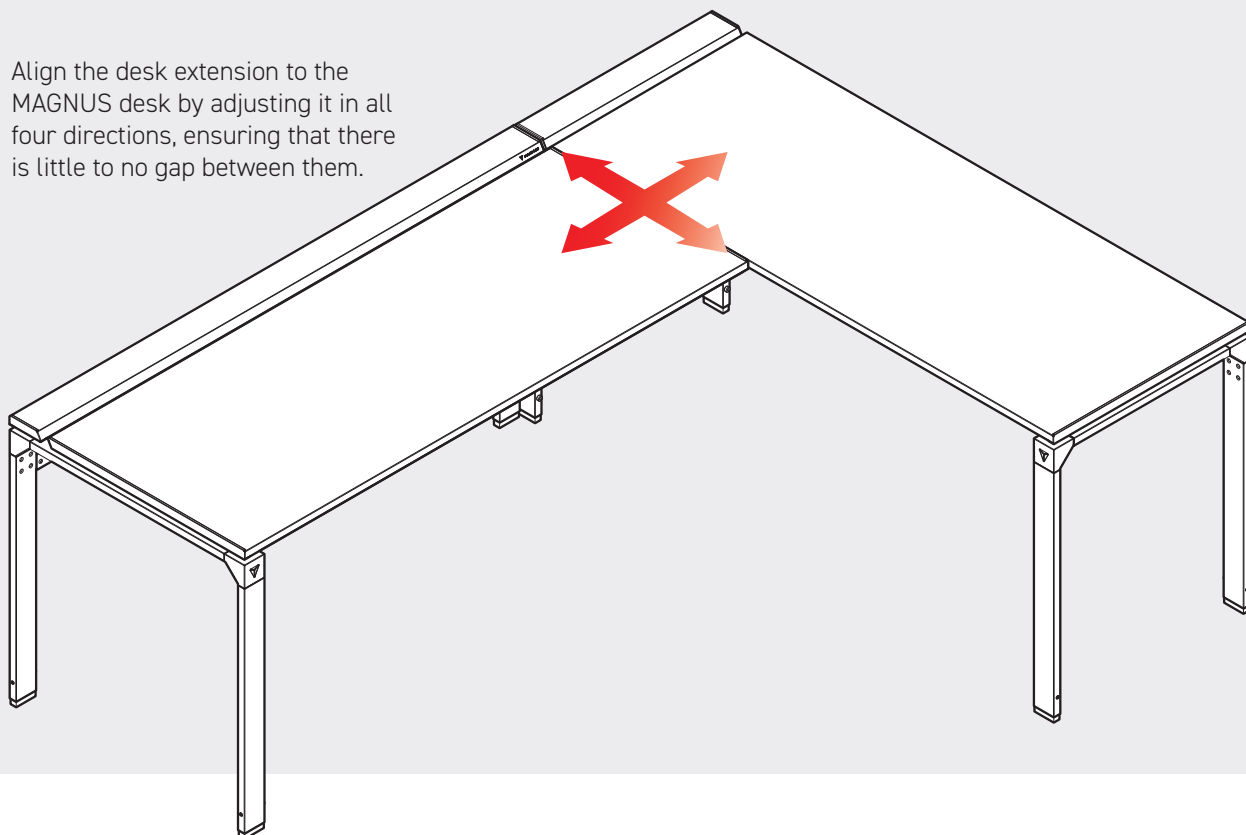

05

Using the larger height adjustment Allen key, turn anti-clockwise to tighten both fasteners on the connecting bracket.

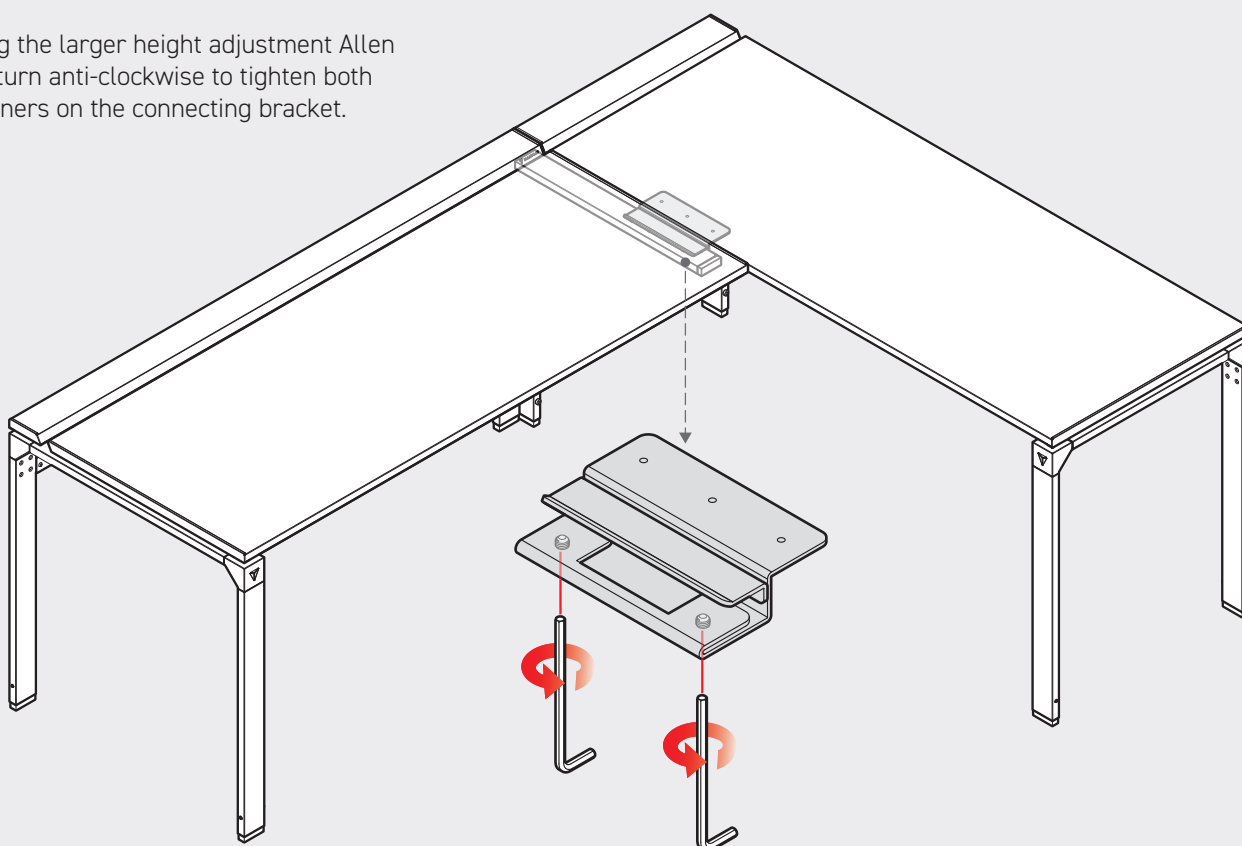

USAGE INSTRUCTIONS

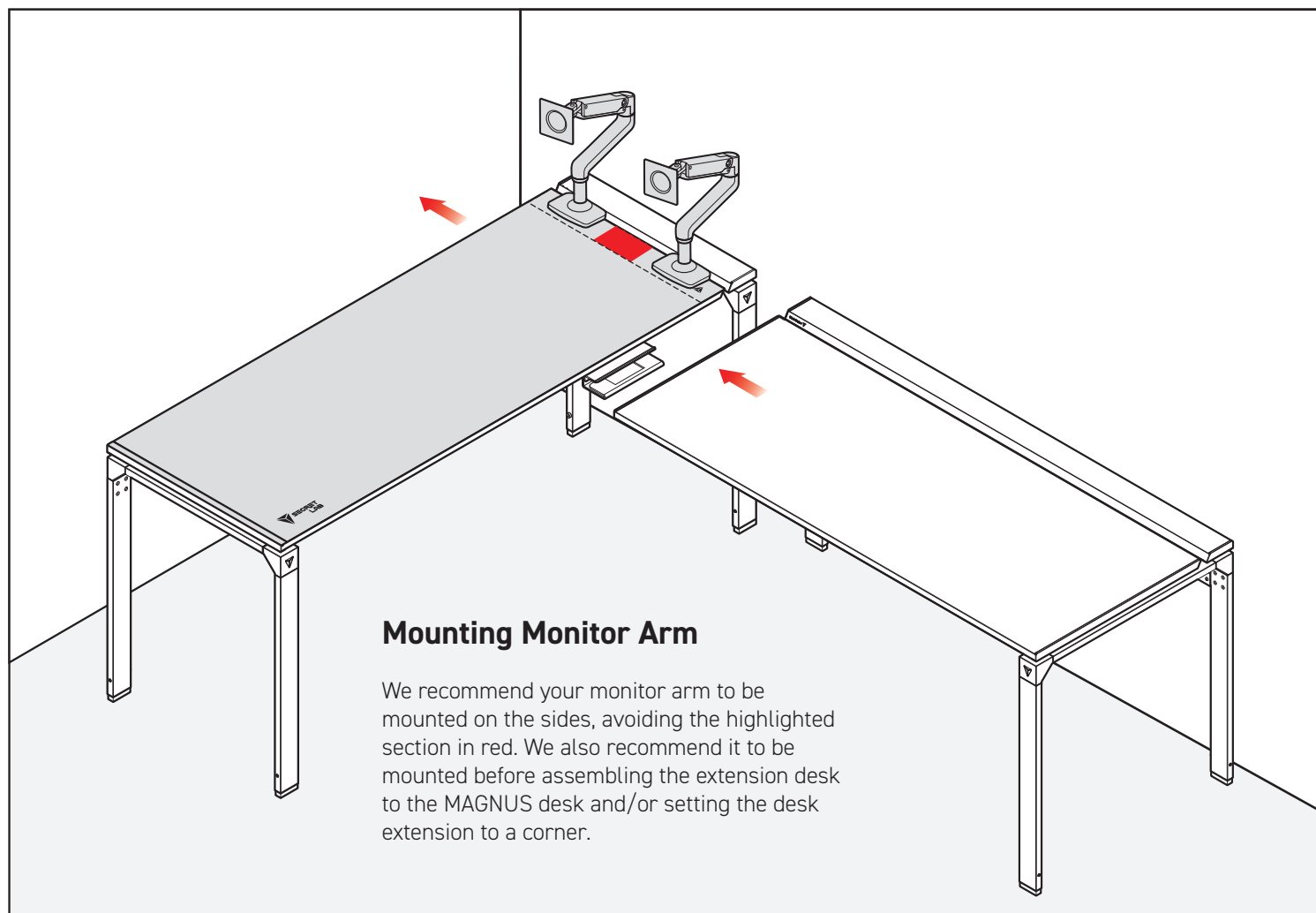
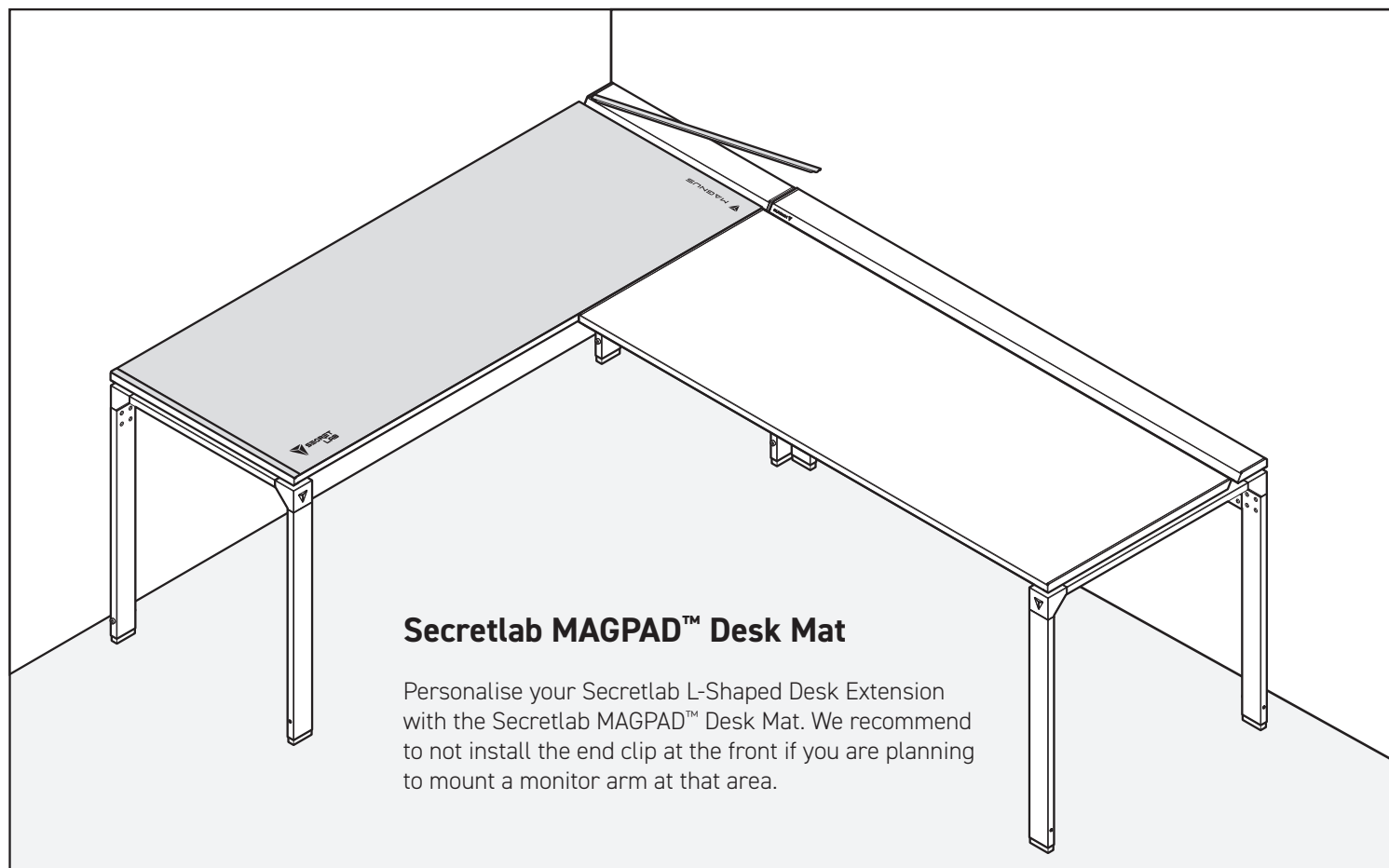

USAGE INSTRUCTIONS

